

JAYCEE PARK PLAYGROUND IMPROVEMENTS

GRAND LEDGE, EATON COUNTY, MICHIGAN

GENERAL PROJECT NOTES:

1. ORIGINAL BASE SURVEY PROVIDED BY:
WOLVERINE ENGINEERS & SURVEYORS, INC. on 1/22/2025
PH: 517-337-7579
2. BENCHMARK: DESC. - FOUND NAIL, WEST SIDE OF UTILITY POLE, NAVD88 ELEV.: 807.98'
3. ALL UNITS OF MEASURE ARE IN ENGLISH.
4. THE CONTRACTOR(S) SHALL NOTIFY ALL EXISTING UTILITY COMPANIES PRIOR TO THE START OF CONSTRUCTION.
5. ALL WORK SHALL CONFORM TO THE CURRENT STANDARD SPECIFICATIONS OF ALL STATE AND LOCAL APPLICABLE AUTHORITIES.
6. CONTRACTOR(S) TO NOTIFY CITY OF GRAND LEDGE 48 HOURS PRIOR TO THE START OF ANY PHASE OF CONSTRUCTION.
7. THE CONTRACTOR(S) SHALL OBTAIN ANY/ALL NECESSARY PERMITS FROM ALL APPLICABLE AGENCIES, PRIOR TO CONSTRUCTION.
8. THE CONTRACTOR(S) IS RESPONSIBLE FOR MAINTAINING ALL PREVIOUSLY INSTALLED S.E.S.C. MEASURES INCLUDING RESTORATION OF ALL DAMAGED AREAS OUTSIDE OF THE CONSTRUCTION LIMITS. AND INSTALLING AND MAINTAINING ALL NEW S.E.S.C. MEASURES.
9. CONTRACTOR(S) SHALL BE RESPONSIBLE FOR REPLACEMENT OR REPAIR OF ANY EXISTING UTILITIES OR OTHER SITE FEATURES THAT ARE DAMAGED DURING CONSTRUCTION TO THE SATISFACTION AND APPROVAL OF THE APPROPRIATE UTILITY COMPANY. OTHER EXISTING SITE ELEMENTS THAT ARE DAMAGED MUST BE REPAIRED OR REPLACED TO THE SATISFACTION AND APPROVAL OF THE OWNER.
10. NOTIFY MISS DIG AT 811 OR 1-800-482-7171, 72 HOURS PRIOR TO START OF CONSTRUCTION.
11. CONTRACTOR(S) SHALL BE RESPONSIBLE FOR ANY COORDINATION WITH SUBCONTRACTORS OR UTILITY COMPANIES AS REQUIRED TO ACCOMPLISH THEIR CONSTRUCTION OPERATIONS.
12. AS AN AID TO THE CONTRACTOR(S), VARIOUS UTILITIES ARE SHOWN ON THE PLAN. ALL INFORMATION CONCERNING ALL UTILITIES SHOWN ON THE PLAN ARE TAKEN FROM AVAILABLE RECORDS. THE OWNER OR ARCHITECT DOES NOT GUARANTEE THEIR LOCATION AND/OR ELEVATION. THE CONTRACTOR(S) SHALL BE RESPONSIBLE FOR MAKING HIMSELF FAMILIAR WITH THE EXACT LOCATIONS AND/OR ELEVATIONS OF ALL EXISTING UTILITIES AND REFLECT THAT IN THEIR BID.
13. IT IS UNDERSTOOD THAT THE CONTRACTOR(S) SHALL PERFORM ALL WORK UNDER THIS CONTRACT IN ACCORDANCE WITH ALL APPLICABLE PROVISIONS, POLICES, RULES AND STANDARDS OF THE MICHIGAN OCCUPATIONAL SAFETY AND HEALTH ACT (MOSHA) BEING ACT 154 OF THE PUBLIC ACTS OF 1974 AND AS AMENDED.
14. ANY QUANTITIES GIVEN WITHIN THESE PLANS AND SPECIFICATIONS ARE APPROXIMATIONS ONLY AND SHOULD NOT BE USED TO DETERMINE COSTS. ALL QUANTITIES SHOULD BE VERIFIED BY THE CONTRACTOR(S) FOR BIDDING PURPOSES. THIS IS A LUMP SUM BID. UNIT PRICES WILL BE TAKEN FOR SPECIFIC ITEMS THAT MAY BE NECESSARY TO ADD OR DELETE DURING PROJECT CONSTRUCTION.
15. CONTRACTOR IS RESPONSIBLE FOR ALL STAKING AND LAYOUT FOR THIS PROJECT. THIS INCLUDES GRADES AND ESTABLISHMENT OF A BENCHMARK.
16. CONTRACTOR TO PROVIDE ALL TRAFFIC CONTROL DURING CONSTRUCTION. ALL TRAFFIC CONTROL SHALL CONFORM TO CURRENT MUTCD STANDARDS.
17. ANY ITEMS INDICATED TO BE REMOVED ARE TO BE LEGALLY DISPOSED OF OFF-SITE UNLESS OTHERWISE NOTED.
18. ALL PERSONNEL ARE REQUIRED TO WEAR HARD HATS WITHIN WORK ZONES AND COMPLY WITH ALL MOSHA STANDARDS.
19. CONTRACTOR SHALL PERFORM DAILY CLEAN UP OF MATERIALS AND DEBRIS GENERATED BY THEIR WORK WITHIN THE PROJECT LIMITS AND IN PUBLIC AREAS IN WHICH THEY CREATE DEBRIS AND/OR TRACKING OF SOIL MATERIALS.
20. CONTRACTOR IS RESPONSIBLE FOR SECURITY OF THEIR OWN TOOLS, EQUIPMENT, MATERIALS, ETC. TO GUARD AGAINST FIRE, THEFT, VANDALISM, AND/OR WEATHER DAMAGE.
21. CONTRACTOR TO COORDINATE CONSTRUCTION SCHEDULE AND DISRUPTIONS OF NORMAL ACTIVITIES WITH OWNER.
22. THE OWNER WILL PROVIDE CONSTRUCTION MATERIAL TESTING. CONTRACTOR SHALL COORDINATE TESTING WITH OWNER'S TESTING AGENCY.

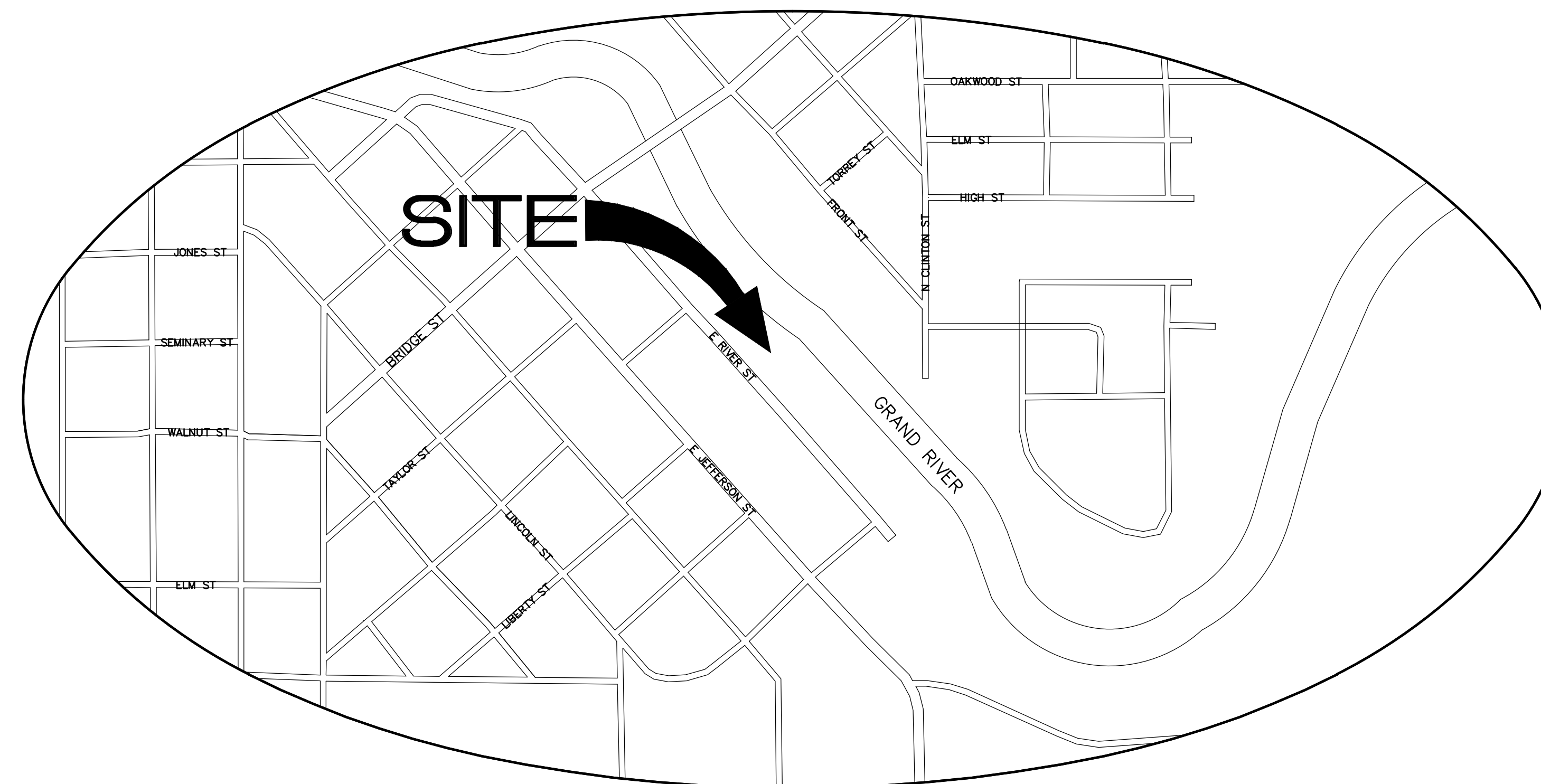

Sheet List Table

Sheet Number	Sheet Title
C0.0	COVER
C1.0	EXISTING CONDITIONS
C2.0	DEMOLITION PLAN
C3.0	SITE LAYOUT PLAN
C3.1	LAYOUT ENLARGEMENTS
C3.2	PLAY SURFACE DIAGRAM
C4.0	DETAILS
C5.0	SITE UTILITY PLAN
C6.0	GRADING PLAN
C7.0	SESC PLAN
C7.1	SESC DETAILS
L1.0	LANDSCAPE PLAN

ENGINEER
SPALDING DEDECKER
313 N. CAPITOL AVE., SUITE 100
LANSING, MI 48933
(517) 679-4400

OWNER
CITY OF GRAND LEDGE
310 GREENWOOD STREET
GRAND LEDGE, MI 48837
(517) 627-2149



Engineering and Surveying
Excellence Since 1954

Lansing, MI

www.sda-eng.com
(800) 598-1600



Plotted: Jun 18, 2025, 12:24 PM by user: 1181 — Saved: 6/10/2025 by user: 1181
 L:\UD Projects\UD25002 — Lantton-Jaycee Park\DWG\Xref\UD25002STP.dwg

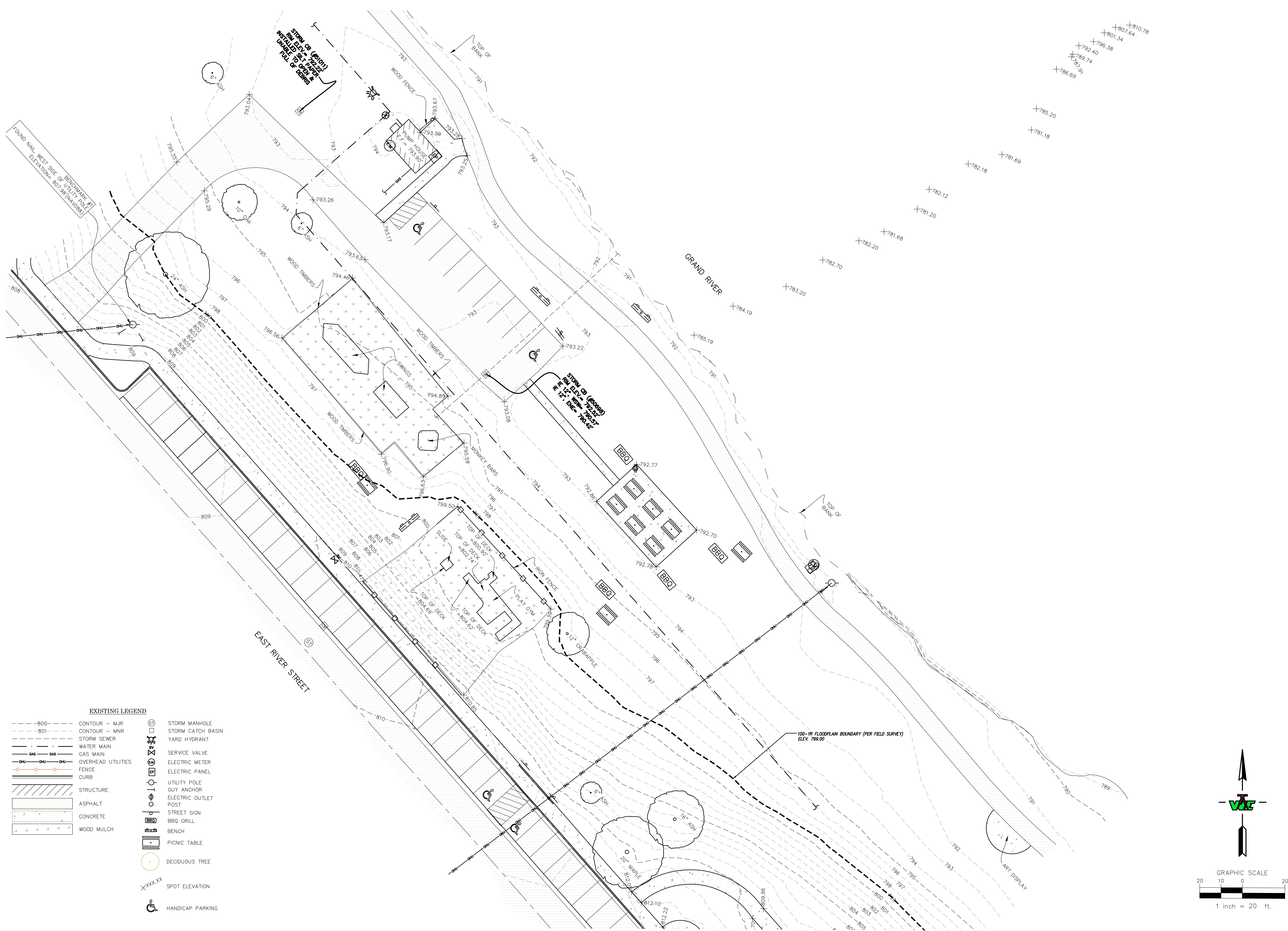

EXISTING LEGEND

---800---	CONTOUR - MJR	⊙	STORM MANHOLE
---801---	CONTOUR - MNR	⊠	STORM CATCH BASIN
---	STORM SEWER	⊞	YARD HYDRANT
---	WATER MAIN	⊞	SERVICE VALVE
---	GAS MAIN	⊞	ELECTRIC METER
---	OVERHEAD UTILITIES	⊞	ELECTRIC PANEL
---	FENCE	⊞	UTILITY POLE
---	CURB	⊞	GUY ANCHOR
---	STRUCTURE	⊞	ELECTRIC OUTLET
---	ASPHALT	⊞	POST
---	CONCRETE	⊞	STREET SIGN
---	WOOD MULCH	⊞	BBQ GRILL
⊙	DECIDUOUS TREE	⊞	BENCH
Xxxx	SPOT ELEVATION	⊞	PICNIC TABLE
♿	HANDICAP PARKING		

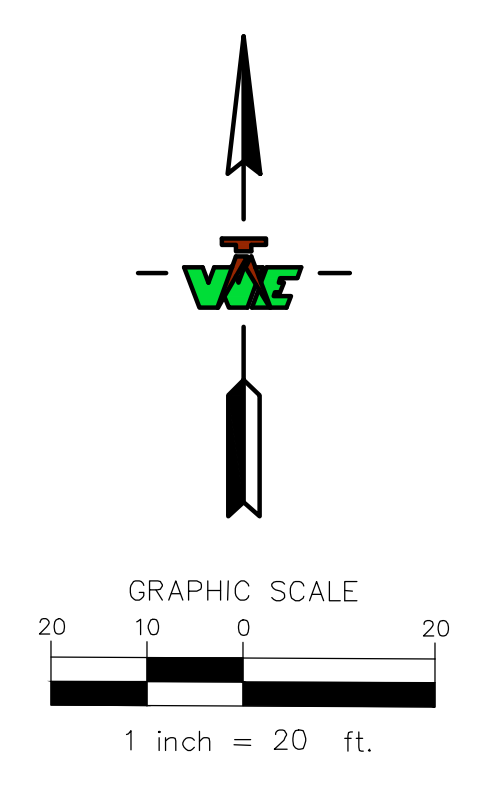

SPALDING DeDECKER
 Engineers | Planners | Surveyors
 Excellence Since 1954

313 N. Capitol Ave, Suite 100
 Lansing, MI 48933
 Phone (517) 679-4400

Headquarters
 Rochester Hills

Branch Offices
 Detroit | Grand Rapids | Novi | Lansing

www.sda-eng.com
 (800) 598-1600



811
 Know what's below.
 Call before you dig.

PRIOR TO CONSTRUCTION, ALL LOCATIONS AND DEPTHS OF EXISTING UTILITIES (IN CONFLICT WITH PROPOSED IMPROVEMENTS) SHALL BE VERIFIED IN THE FIELD. CALL MISS DIG'S WORKING DAYS PRIOR TO CONSTRUCTION.

UTILITY NOTE

UTILITY INFORMATION ON THIS DRAWING MAY BE FROM INFORMATION DISCLOSED TO THIS FIRM BY THE VARIOUS UTILITY COMPANIES, CITY/COUNTY AGENCIES AND OTHER VARIOUS SOURCES. UNDERGROUND UTILITIES WHICH ARE ON PRIVATE PROPERTY ARE USUALLY NOT DELINEATED UPON A UTILITY COMPANY'S PUBLISHED PLANS. THEIR LOCATION, IF SHOWN UPON THIS SURVEY, ARE APPROXIMATED FROM FOUND PAINT MARKERS, ETC., AS LOCATED BY THIS FIRM FROM SOURCES WHICH ARE UNKNOWN. NO GUARANTEE IS GIVEN AS TO THE COMPLETENESS OR ACCURACY THEREOF.

COPYRIGHT © SPALDING DeDECKER ASSOCIATES, INC. THIS DRAWING AND THE SUBJECT MATTER CONTAINED THEREON IS PROPRIETARY AND IS NOT TO BE USED OR REPRODUCED WITHOUT WRITTEN PERMISSION OF SPALDING DeDECKER ASSOCIATES, INC.

JAYCEE PARK PLAYGROUND IMPROVEMENTS

525 E RIVER ST.
 GRAND LEDGE, MI

EXISTING CONDITIONS

TOWN - 4 NORTH RANGE - 4 WEST
 GRAND LEDGE
 EATON COUNTY, MICHIGAN

NO.	DATE	REVISION
01	08.18.2025	FOR BIDS

VERIFY SCALES
 BAR IS ONE INCH ON ORIGINAL DRAWING
 IF NOT ONE INCH ON THIS SHEET,
 ADJUST SCALES ACCORDINGLY

DRAWN BY NW	DATE 5/22/2025
DESIGNER NW	DATE 4/30/2025
CHECKED RF	DATE 5/22/2025
PROJECT MANAGER NW	BID PLAN DATE
DEPARTMENT MANAGER APPROVAL TD	DATE
JOB NO. UD25002	DRAWING NO. UD25002STP
SCALE: 1" = 20'	SHEET NO. C1.0

Plotted: Jun 18, 2025, 12:24 PM by user: 1181 - Saved: 6/18/2025 by user: 1181
 L:\UD_Projects\UD25002 - Lantson_Joycee Park\DWG\UD25002DEM.dwg

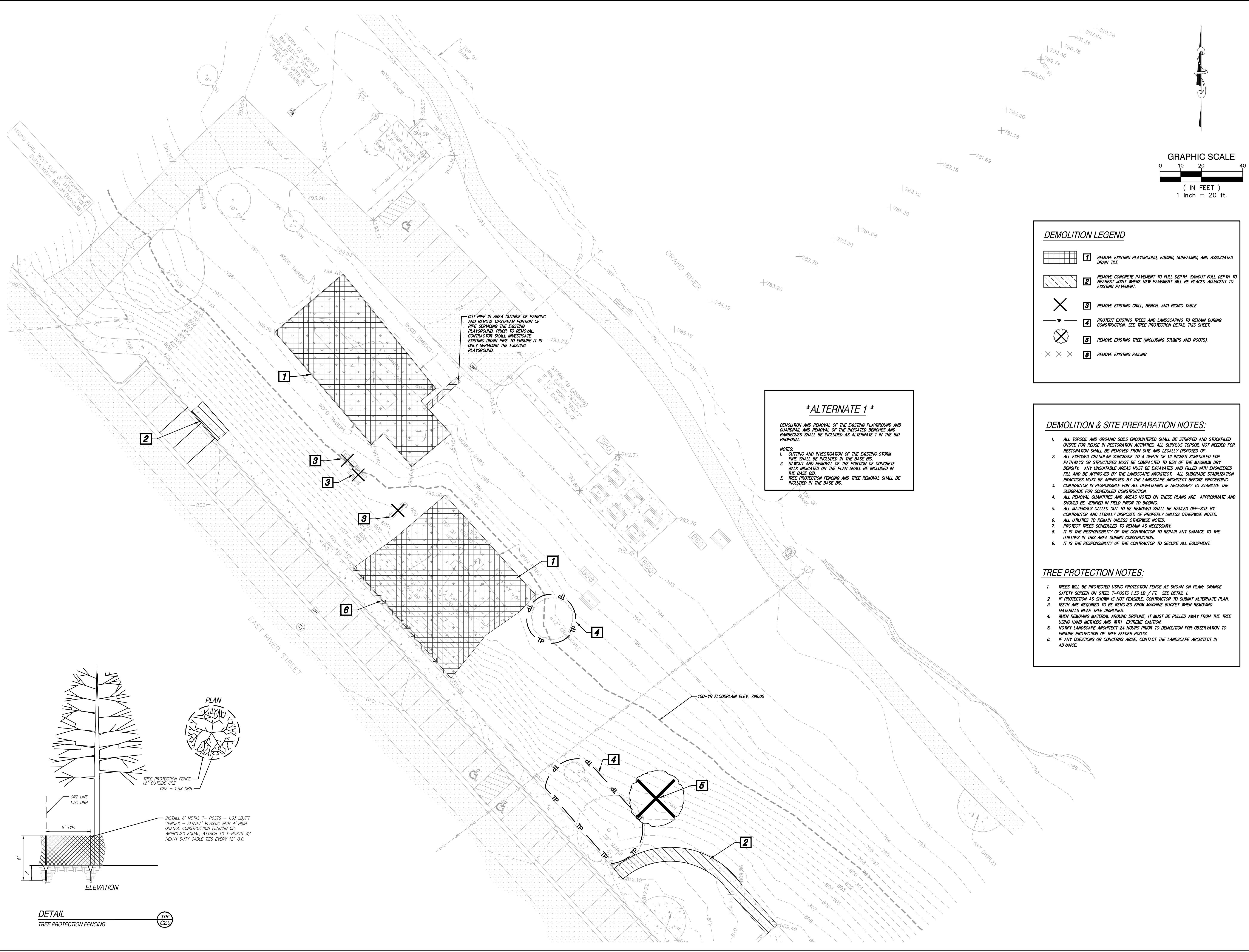

DEMOLITION LEGEND

	1 REMOVE EXISTING PLAYGROUND, EDGING, SURFACING, AND ASSOCIATED DRAIN TILE
	2 REMOVE CONCRETE PAVEMENT TO FULL DEPTH. SAWCUT FULL DEPTH TO NEAREST JOINT WHERE NEW PAVEMENT WILL BE PLACED ADJACENT TO EXISTING PAVEMENT.
	3 REMOVE EXISTING GRILL, BENCH, AND PICNIC TABLE
	4 PROTECT EXISTING TREES AND LANDSCAPING TO REMAIN DURING CONSTRUCTION. SEE TREE PROTECTION DETAIL THIS SHEET.
	5 REMOVE EXISTING TREE (INCLUDING STUMPS AND ROOTS).
	6 REMOVE EXISTING RAILING

ALTERNATE 1

DEMOLITION AND REMOVAL OF THE EXISTING PLAYGROUND AND GUARDRAIL AND REMOVAL OF THE INDICATED BENCHES AND BARBECUES SHALL BE INCLUDED AS ALTERNATE 1 IN THE BID PROPOSAL.

NOTES:

- CUTTING AND INVESTIGATION OF THE EXISTING STORM PIPE SHALL BE INCLUDED IN THE BASE BID.
- SAWCUT AND REMOVAL OF THE PORTION OF CONCRETE WALK INDICATED ON THE PLAN SHALL BE INCLUDED IN THE BASE BID.
- TREE PROTECTION FENCING AND TREE REMOVAL SHALL BE INCLUDED IN THE BASE BID.

DEMOLITION & SITE PREPARATION NOTES:

- ALL TOPSOIL AND ORGANIC SOILS ENCOUNTERED SHALL BE STRIPPED AND STOCKPILED ON-SITE FOR REUSE IN RESTORATION ACTIVITIES. ALL SURPLUS TOPSOIL NOT NEEDED FOR RESTORATION SHALL BE REMOVED FROM SITE AND LEGALLY DISPOSED OF.
- ALL EXPOSED GRANULAR SUBGRADE TO A DEPTH OF 12 INCHES SCHEDULED FOR PATHWAYS OR STRUCTURES MUST BE COMPACTED TO 98% OF THE MAXIMUM DRY DENSITY. ANY UNSUITABLE AREAS MUST BE EXCAVATED AND FILLED WITH ENGINEERED FILL AND BE APPROVED BY THE LANDSCAPE ARCHITECT. ALL SUBGRADE STABILIZATION PRACTICES MUST BE APPROVED BY THE LANDSCAPE ARCHITECT BEFORE PROCEEDING.
- CONTRACTOR IS RESPONSIBLE FOR ALL DENEATURING IF NECESSARY TO STABILIZE THE SUBGRADE FOR SCHEDULED CONSTRUCTION.
- ALL REMOVAL QUANTITIES AND AREAS NOTED ON THESE PLANS ARE APPROXIMATE AND SHOULD BE VERIFIED IN FIELD PRIOR TO BIDDING.
- ALL MATERIALS CALLED OUT TO BE REMOVED SHALL BE HAULED OFF-SITE BY CONTRACTOR AND LEGALLY DISPOSED OF PROPERLY UNLESS OTHERWISE NOTED.
- PROTECT TREES SCHEDULED TO REMAIN AS NECESSARY.
- IT IS THE RESPONSIBILITY OF THE CONTRACTOR TO REPAIR ANY DAMAGE TO THE UTILITIES IN THIS AREA DURING CONSTRUCTION.
- IT IS THE RESPONSIBILITY OF THE CONTRACTOR TO SECURE ALL EQUIPMENT.

TREE PROTECTION NOTES:

- TREES WILL BE PROTECTED USING PROTECTION FENCE AS SHOWN ON PLAN; ORANGE SAFETY SCREEN ON STEEL T-POSTS 1.33 LB / FT. SEE DETAIL 1.
- IF PROTECTION AS SHOWN IS NOT FEASIBLE, CONTRACTOR TO SUBMIT ALTERNATE PLAN.
- TEETH ARE REQUIRED TO BE REMOVED FROM MACHINE BUCKET WHEN REMOVING MATERIALS NEAR TREE DRIPLINES.
- WHEN REMOVING MATERIAL AROUND DRIPLINE, IT MUST BE PULLED AWAY FROM THE TREE USING HAND METHODS AND WITH EXTREME CAUTION.
- NOTIFY LANDSCAPE ARCHITECT 24 HOURS PRIOR TO DEMOLITION FOR OBSERVATION TO ENSURE PROTECTION OF TREE FEEDER ROOTS.
- IF ANY QUESTIONS OR CONCERNS ARISE, CONTACT THE LANDSCAPE ARCHITECT IN ADVANCE.

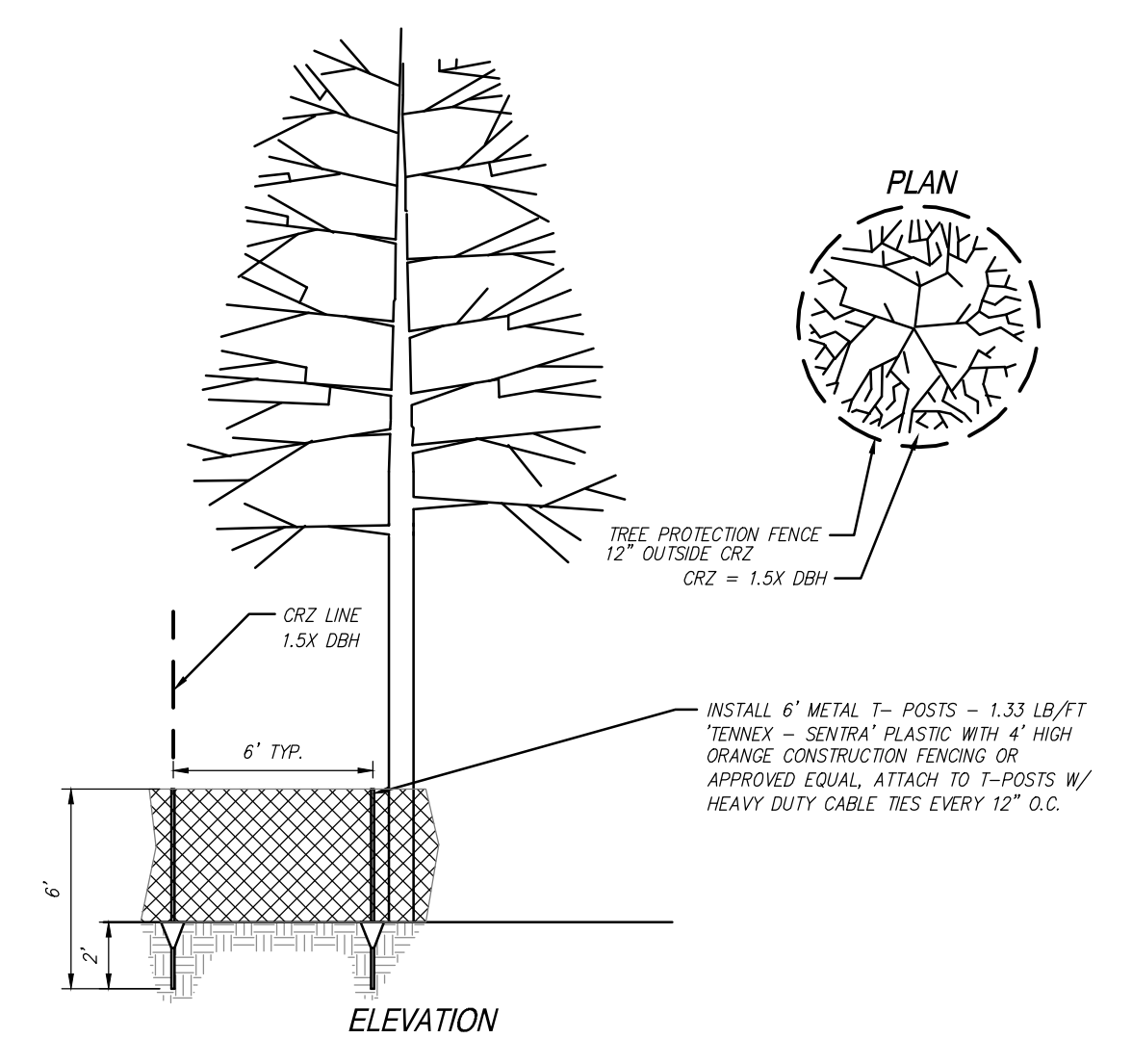

DETAIL
TREE PROTECTION FENCING

SPALDING DeDECKER
 Engineers | Planners | Surveyors
 Excellence Since 1954
 313 N. Capitol Ave, Suite 100
 Lansing, MI 48933
 Phone (517) 679-4400
 Headquarters
 Rochester Hills
 Branch Offices
 Detroit | Grand Rapids | Novi | Lansing

www.sda-eng.com
(800) 598-1600

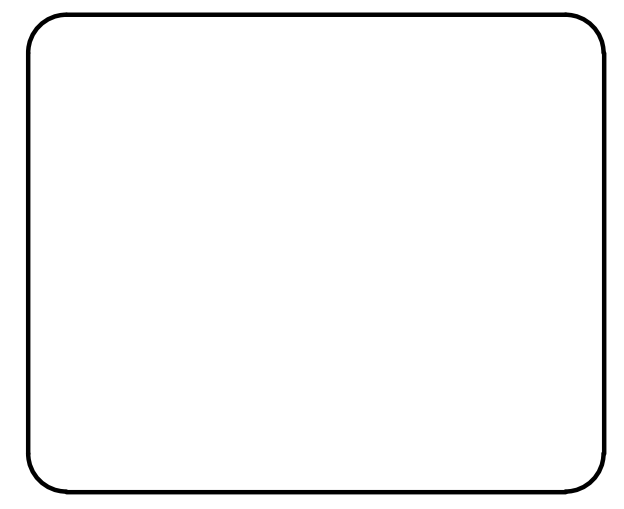

811
 Know what's below.
 Call before you dig.

PRIOR TO CONSTRUCTION, ALL LOCATIONS AND DEPTHS OF EXISTING UTILITIES (IN CONFLICT WITH PROPOSED IMPROVEMENTS) SHALL BE VERIFIED IN THE FIELD. CALL MISS DIG 3 WORKING DAYS PRIOR TO CONSTRUCTION.

UTILITY NOTE

UTILITY INFORMATION ON THIS DRAWING MAY BE FROM INFORMATION DISCLOSED TO THIS FIRM BY THE VARIOUS UTILITY COMPANIES, CITY/COUNTY AGENCIES AND OTHER VARIOUS SOURCES. UNDERGROUND UTILITIES WHICH ARE ON PRIVATE PROPERTY ARE USUALLY NOT DEPICTED UPON A UTILITY COMPANY'S PUBLISHED PLANS. THEIR LOCATION, IF SHOWN UPON THIS SURVEY, ARE APPROXIMATED FROM FOUND PAINT MARKS/STAKES, ETC. AS LOCATED BY THIS FIRM FROM SOURCES WHICH ARE UNKNOWN. NO GUARANTEE IS GIVEN AS TO THE COMPLETENESS OR ACCURACY THEREOF.

COPYRIGHT © SPALDING DEDECKER ASSOCIATES, INC. THIS DRAWING AND THE SUBJECT MATTER CONTAINED THEREON IS PROPRIETARY AND IS NOT TO BE USED OR REPRODUCED WITHOUT WRITTEN PERMISSION OF SPALDING DEDECKER ASSOCIATES, INC.

JAYCEE PARK PLAYGROUND IMPROVEMENTS

525 E RIVER ST.
GRAND LEDGE, MI

DEMOLITION PLAN

TOWN - 4 NORTH RANGE - 4 WEST
GRAND LEDGE
EATON COUNTY, MICHIGAN

NO.	DATE	REVISION
01	06.11.2025	FOR BIDS

VERIFY SCALES	
BAR IS ONE INCH ON ORIGINAL DRAWING	
IF NOT ONE INCH ON THIS SHEET, ADJUST SCALES ACCORDINGLY	

DRAFTER NW	DATE 5/22/2025
DESIGNER NW	DATE 4/30/2025
CHECKED RF	DATE 5/22/2025
PROJECT MANAGER NW	BID PLAN DATE
DEPARTMENT MANAGER APPROVAL TD	DATE
JOB NO. UD25002	DRAWING NO. UD25002DEM
SCALE: 1" = 20'	SHEET NO. C2.0

NO.	DATE	REVISION
01	06.18.2025	FOR BIDS

VERIFY SCALES
 BAR IS ONE INCH ON ORIGINAL DRAWING
 IF NOT ONE INCH ON THIS SHEET,
 ADJUST SCALES ACCORDINGLY

DATE	DATE
5/22/2025	4/30/2025
4/30/2025	5/22/2025

DRAFTER	DATE
NW	5/22/2025
DESIGNER	4/30/2025
NW	4/30/2025
CHECKED	DATE
RF	5/22/2025
PROJECT MANAGER	BID PLAN DATE
NW	
DEPARTMENT MANAGER APPROVAL	DATE
TD	

JOB NO.	DRAWING NO.
UD25002	UD25002PAV
SCALE:	SHEET NO.
1" = 20'	C3.1

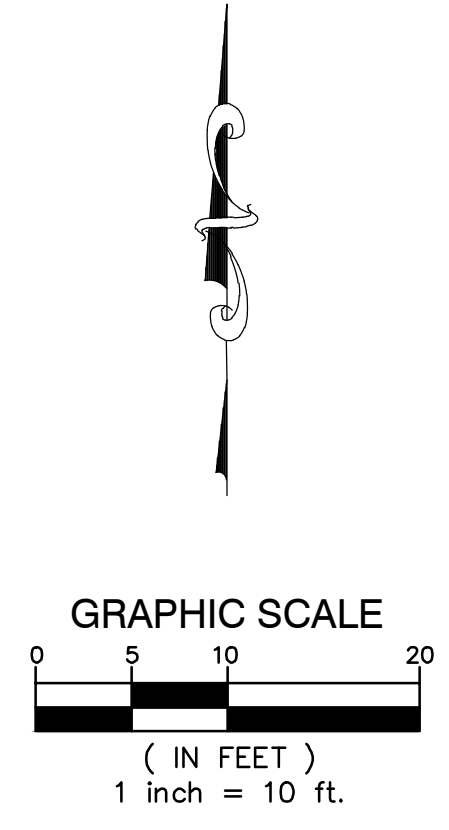

FENCING NOTES

1. AMERSTAR MONTAGE II, MAJESTIC STYLE, 42" HT., 3-RAIL, FLUSH BOTTOM, SURFACE MOUNT, BLACK COLOR, MODEL NO. 2446000, OR APPROVED EQUAL.
2. CONTRACTOR SHALL FIELD VERIFY MEASUREMENTS PRIOR TO FABRICATION.
3. ADA HANDRAIL SHALL BE FABRICATED AND ATTACHED TO FENCE AS SHOWN IN EXAMPLE IMAGE ON SHEET C4.0.
4. INSTALL PER MANUFACTURER'S SPECIFICATIONS.
5. CONTACT: SETH MILLER
 E: SMILLER@AMERSTARFENCE.COM, P: 800.321.8724

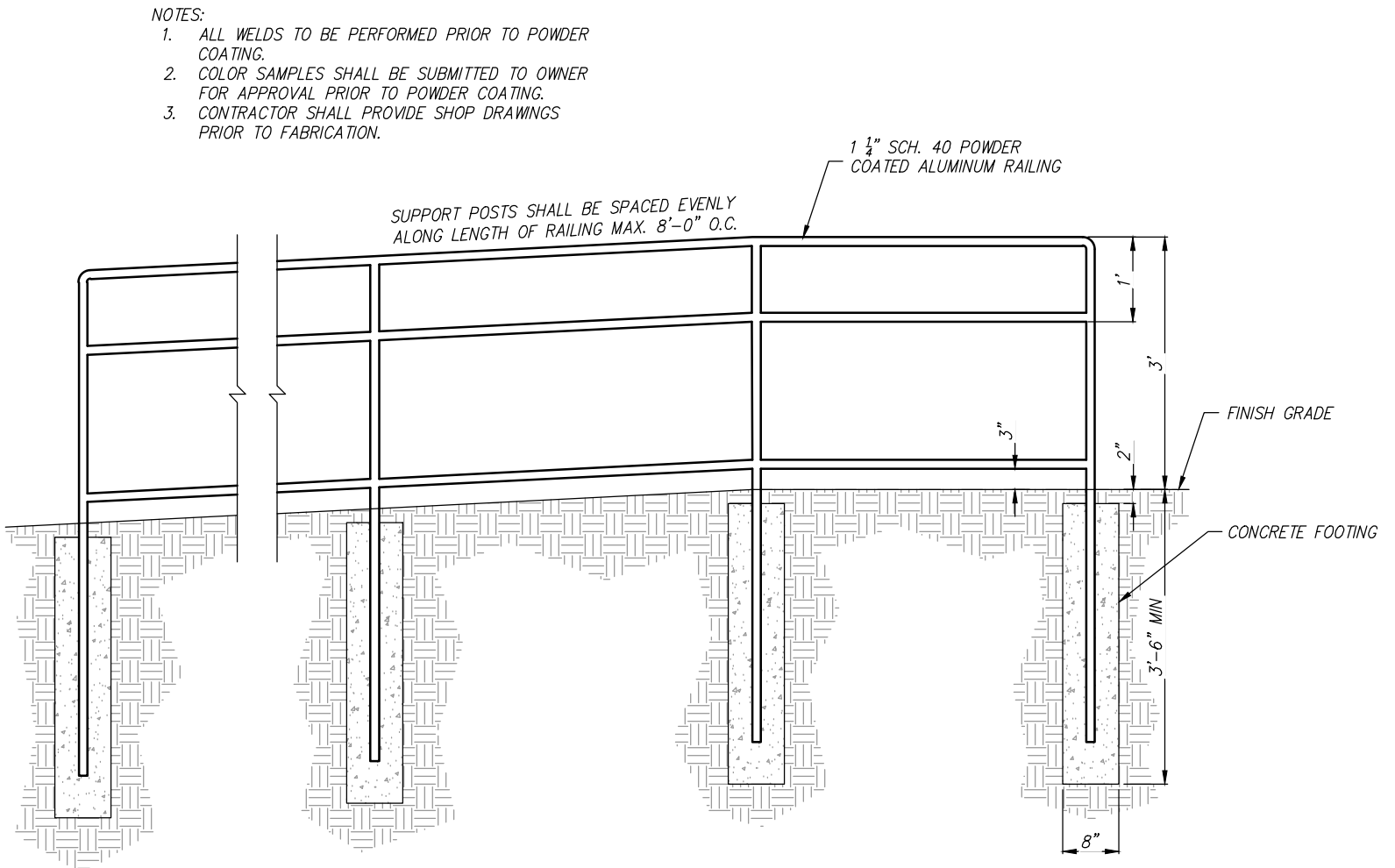
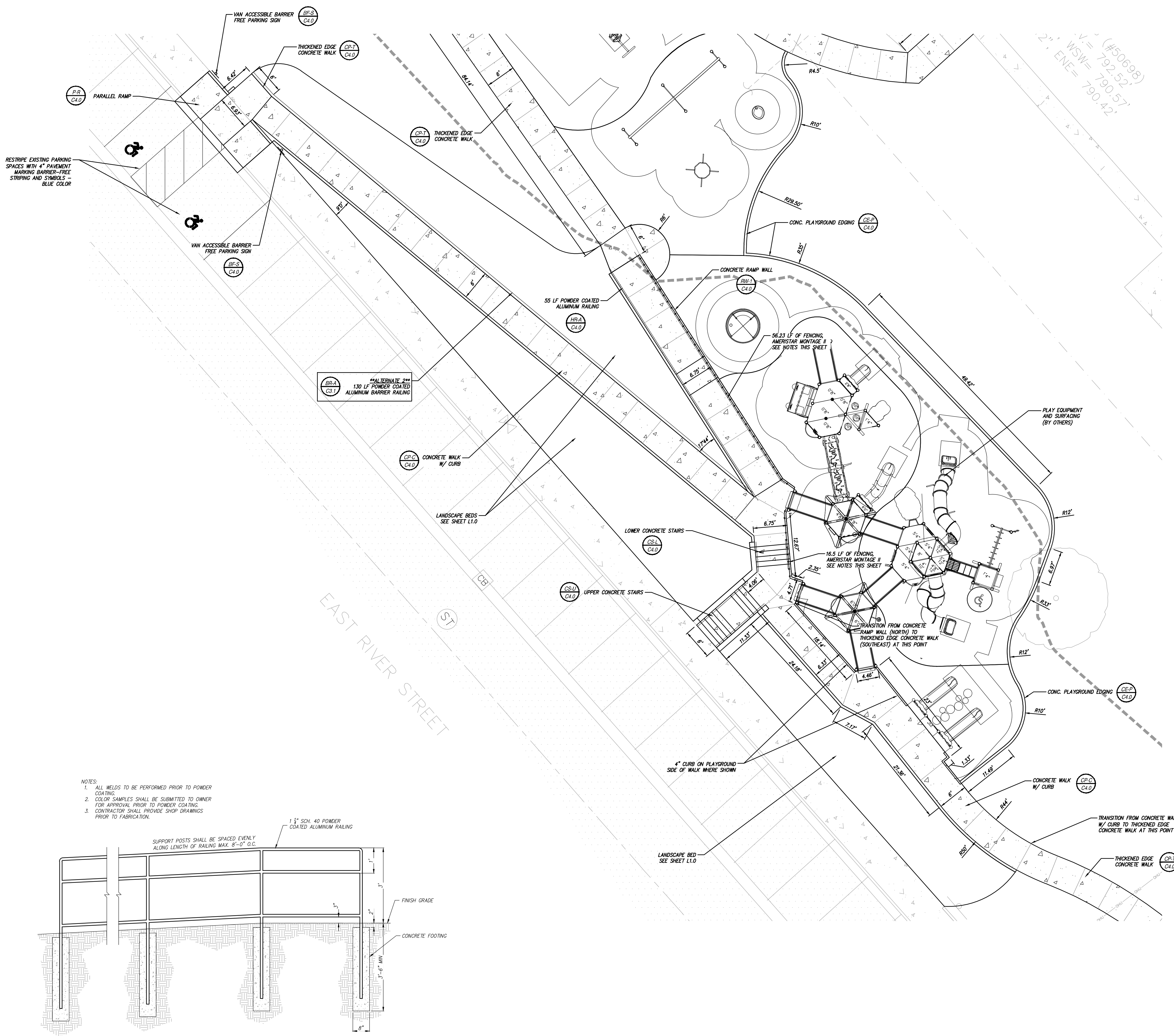

DETAIL (ALTERNATE 2)
 RAMP HANDRAIL

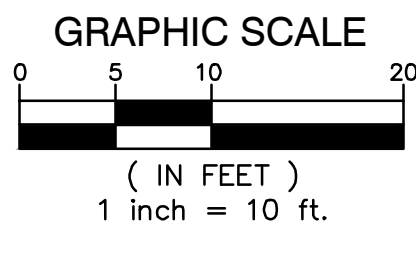

NOTE
 DETAILS ARE SHOWN FOR REFERENCE ONLY. PLAYGROUND SURFACING AND AGGREGATE SUBBASE SHALL BE BY OTHERS

PLAY SURFACING LEGEND	
	1 BLUE POURED-IN-PLACE SURFACING 8" BELOW FINISH GRADE SLOPE 1% TOWARD CENTER DRAIN TILE
	2 BLUE POURED-IN-PLACE SURFACING ON HILL 10" DEPTH BELOW FINISH GRADE
	3 GREEN POURED-IN-PLACE SURFACING 8" BELOW FINISH GRADE SLOPE 1% TOWARD CENTER DRAIN TILE
	4 GREEN POURED-IN-PLACE SURFACING ON HILL 10" DEPTH BELOW FINISH GRADE



SURFACEMAX
 P.O. BOX 577
 EAST AURORA, NY 14052
 PHONE: (716) 652-2039
 FAX: (716) 805-1001
 www.playandpark.com/products/surfacing

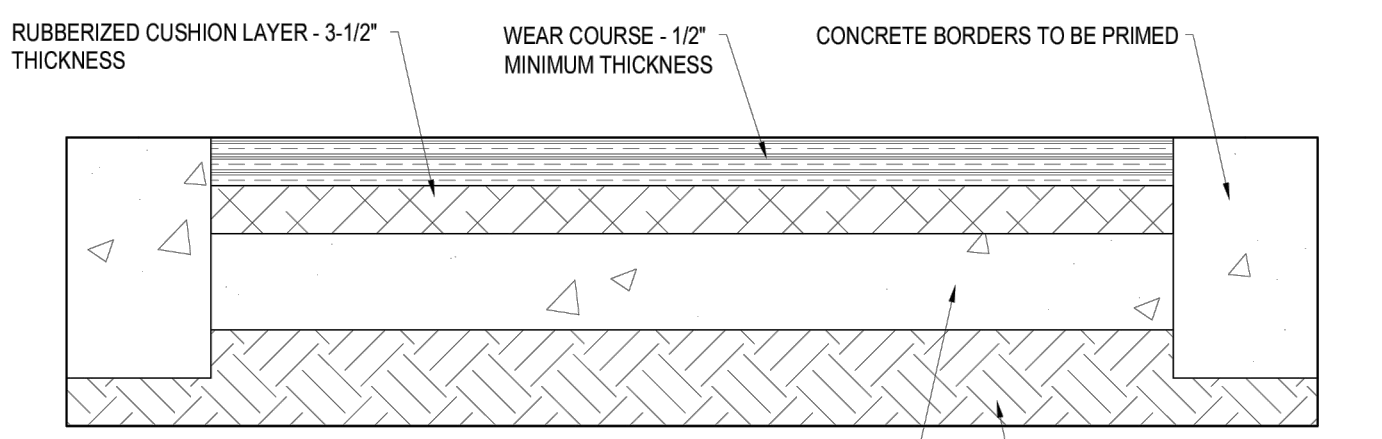

DETAIL 1
 POURED-IN-PLACE SURFACING

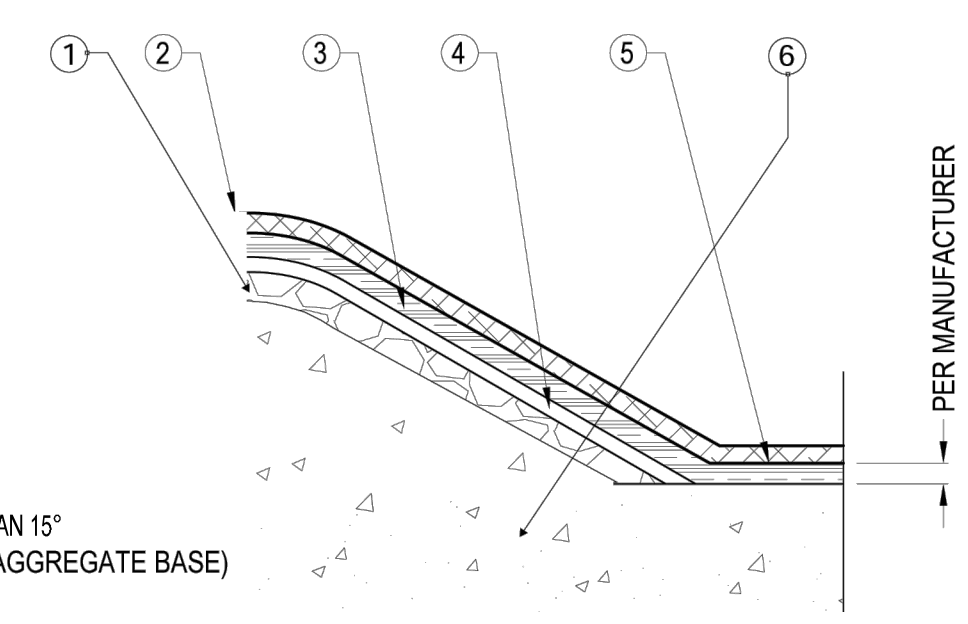

DETAIL 2
 POURED-IN-PLACE SURFACING ON HILL

- LEGEND:**
- 1 4" AGGREGATE BASE COMPACTED TO 95%
 - 2 1/2" COLOR WEAR LAYER
 - 3 3-1/2" RUBBERIZED CUSHION LAYER
 - 4 2" CONCRETE SKIM COAT ON ALL SLOPES GREATER THAN 15°
 - 5 ADJACENT POURED-IN-PLACE SURFACE (4" OVER AGGREGATE BASE)
 - 6 UNDISTURBED SOILS

SPALDING DeDECKER
 Engineers | Planners | Surveyors
 Excellence Since 1954
 313 N. Capitol Ave, Suite 100
 Lansing, MI 48933
 Phone (517) 679-4400
Headquarters
 Rochester Hills
Branch Offices
 Detroit | Grand Rapids | Novi | Lansing

www.sda-eng.com
 (800) 598-1600



811
 Know what's below.
 Call before you dig.

UTILITY NOTE
 UTILITY INFORMATION ON THIS DRAWING MAY BE FROM INFORMATION DISCLOSED TO THIS FIRM BY THE VARIOUS UTILITY COMPANIES, CITY/COUNTY AGENCIES AND OTHER VARIOUS SOURCES. UNDERGROUND UTILITIES WHICH ARE ON PRIVATE PROPERTY ARE USUALLY NOT DELINEATED UPON A UTILITY COMPANY'S PUBLISHED PLANS. THEIR LOCATION, IF SHOWN UPON THIS SURVEY, ARE APPROXIMATED FROM FOUND PAINT MARKS/STAKES, ETC. AS LOCATED BY THIS FIRM FROM SOURCES WHICH ARE UNKNOWN. NO GUARANTEE IS GIVEN AS TO THE COMPLETENESS OR ACCURACY THEREOF.

COPYRIGHT © SPALDING DeDECKER ASSOCIATES, INC. THIS DRAWING AND THE SUBJECT MATTER CONTAINED THEREON IS PROPRIETARY AND IS NOT TO BE USED OR REPRODUCED WITHOUT WRITTEN PERMISSION OF SPALDING DeDECKER ASSOCIATES, INC.

JAYCEE PARK PLAYGROUND IMPROVEMENTS
 525 E RIVER ST.
 GRAND LEDGE, MI

PLAY SURFACE DIAGRAM

TOWN - 4 NORTH RANGE - 4 WEST
 GRAND LEDGE
 EATON COUNTY, MICHIGAN

NO.	DATE	REVISION
01	06.18.2025	FOR BIDS

VERIFY SCALES
 BAR IS ONE INCH ON ORIGINAL DRAWING
 IF NOT ONE INCH ON THIS SHEET,
 ADJUST SCALES ACCORDINGLY

DRAFTER	DATE
NW	5/22/2025
DESIGNER	DATE
NW	4/30/2025
CHECKED	DATE
RF	5/22/2025
PROJECT MANAGER	BID PLAN DATE
NW	
DEPARTMENT MANAGER APPROVAL	DATE
TD	
JOB NO.	DRAWING NO.
UD25002	UD25002PAV
SCALE:	SHEET NO.
1" = 20'	C3.2

Plotted: Jun 18, 2025, 12:24 PM by user: 1181
 L:\UD_Projects\UD25002 - Lawton_Jaycee Park\DWG\UD25002PAV.dwg

NO.	DATE	REVISION
01	06.18.2025	FOR BIDS

VERIFY SCALES	
BAR IS ONE INCH ON ORIGINAL DRAWING IF NOT ONE INCH ON THIS SHEET, ADJUST SCALES ACCORDINGLY	
DRAWER NW	DATE 5/22/2025
DESIGNER NW	DATE 4/30/2025
CHECKED RF	DATE 5/22/2025
PROJECT MANAGER NW	BID PLAN DATE
DEPARTMENT MANAGER APPROVAL TD	DATE
JOB NO. UD25002	DRAWING NO. UD25002DET
SCALE: NA	SHEET NO. C4.0

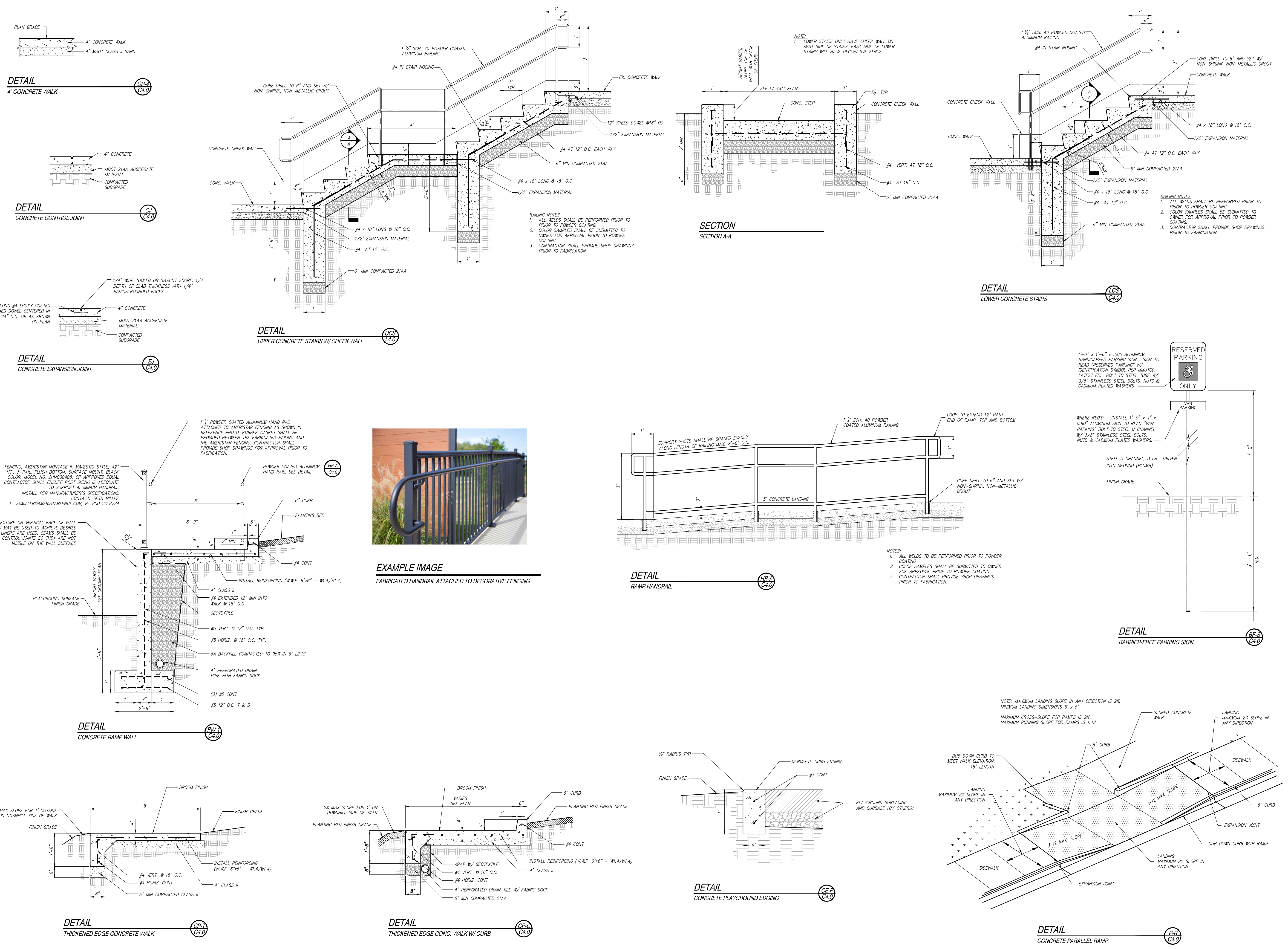

Plotted: Jun 18, 2025, 12:24 PM by user: 1181 - Saved: 6/18/2025 by user: 1181
 L:\UD_Projects\UD25002 - Lantson_Jaycee Park\DWG\UD25002DET.dwg

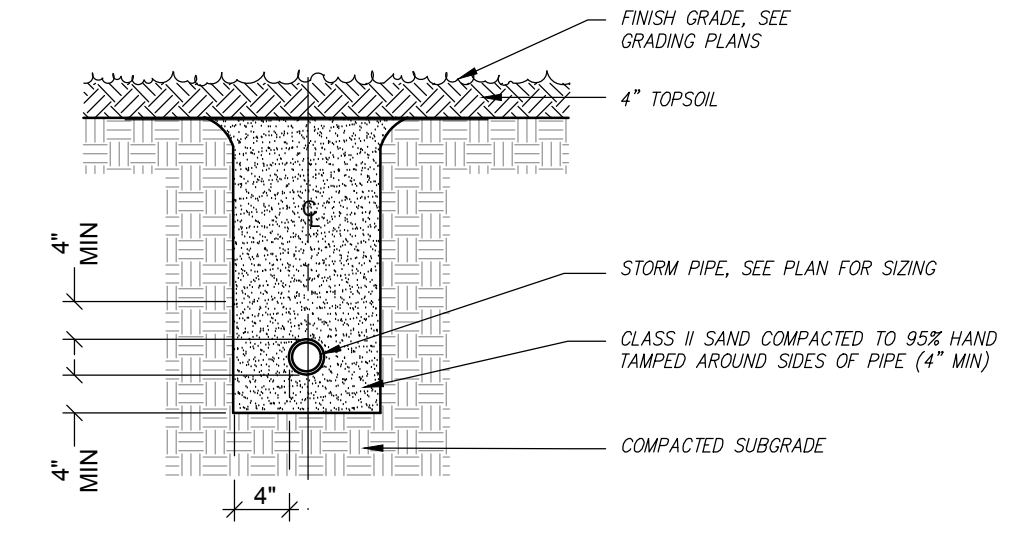
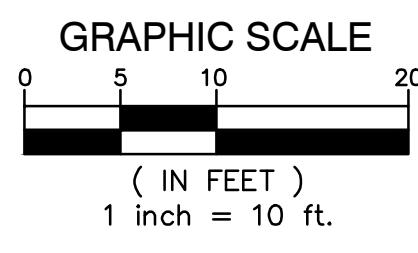
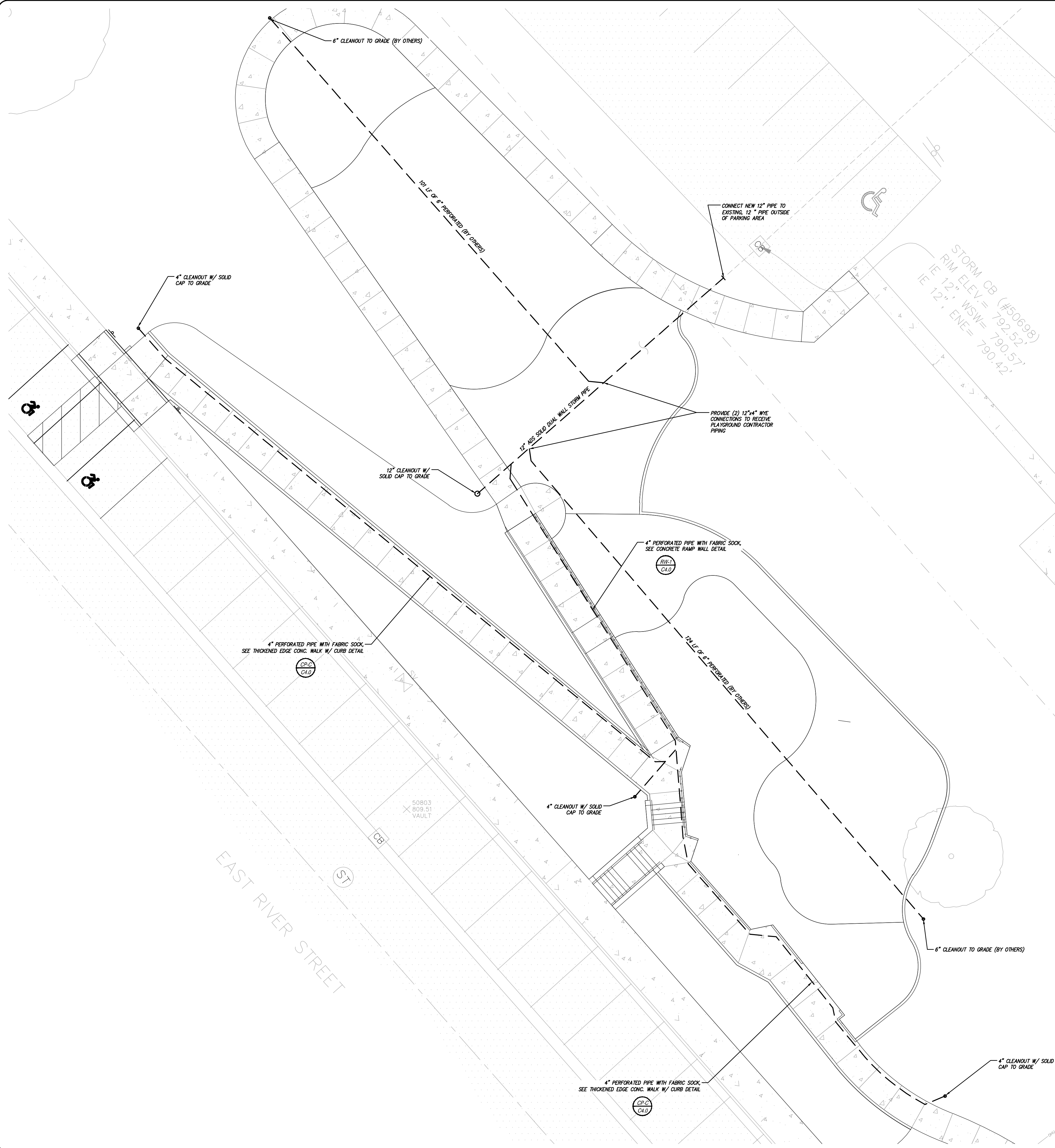

DETAIL
STORM PIPE TRENCH

SPALDING DeDECKER
 Engineers | Planners | Surveyors
 Excellence Since 1954
 313 N. Capitol Ave, Suite 100
 Lansing, MI 48933
 Phone (517) 679-4400
 Headquarters
 Rochester Hills
 Branch Offices
 Detroit | Grand Rapids | Novi | Lansing

www.sda-eng.com
 (800) 598-1600



811
 Know what's below.
 Call before you dig.

PRIOR TO CONSTRUCTION, ALL LOCATIONS AND DEPTHS OF EXISTING UTILITIES IN CONFLICT WITH PROPOSED IMPROVEMENTS SHALL BE VERIFIED IN THE FIELD. CALL MISS DIG 3 WORKING DAYS PRIOR TO CONSTRUCTION.

UTILITY NOTE
 UTILITY INFORMATION ON THIS DRAWING MAY BE FROM INFORMATION DISCLOSED TO THIS FIRM BY THE VARIOUS UTILITY COMPANIES, CITY/COUNTY AGENCIES AND OTHER VARIOUS SOURCES. UNDERGROUND UTILITIES WHICH ARE ON PRIVATE PROPERTY ARE USUALLY NOT DELINEATED UPON A UTILITY COMPANY'S PUBLISHED PLANS. THEIR LOCATION, IF SHOWN UPON THIS SURVEY, ARE APPROXIMATED FROM FOUND PAINT MARKS/STAKES, ETC. AS LOCATED BY THIS FIRM FROM SOURCES WHICH ARE UNKNOWN. NO GUARANTEE IS GIVEN AS TO THE COMPLETENESS OR ACCURACY THEREOF.

COPYRIGHT © SPALDING DeDECKER ASSOCIATES, INC. THIS DRAWING AND THE SUBJECT MATTER CONTAINED THEREON IS PROPRIETARY AND IS NOT TO BE USED OR REPRODUCED WITHOUT WRITTEN PERMISSION OF SPALDING DeDECKER ASSOCIATES, INC.

JAYCEE PARK PLAYGROUND IMPROVEMENTS
 525 E RIVER ST.
 GRAND LEDGE, MI

SITE UTILITY PLAN

TOWN - 4 NORTH RANGE - 4 WEST
 GRAND LEDGE
 EATON COUNTY, MICHIGAN

NO.	DATE	REVISION
01	06.18.2025	FOR BIDS

VERIFY SCALES
 BAR IS ONE INCH ON ORIGINAL DRAWING
 IF NOT ONE INCH ON THIS SHEET,
 ADJUST SCALES ACCORDINGLY

DRAFTER NW	DATE 5/22/2025
DESIGNER NW	DATE 4/30/2025
CHECKED RF	DATE 5/22/2025
PROJECT MANAGER NW	BID PLAN DATE
DEPARTMENT MANAGER APPROVAL TD	DATE
JOB NO. UD25002	DRAWING NO. UD25002UTL
SCALE: 1" = 10'	SHEET NO. C5.0

Plotted: Jun 18, 2025, 12:25 PM by user: 1181
 L:\UD_Projects\UD25002 - Layton_Joycee Park\DWG\UD25002UTL.dwg

Plotfile: Jun 18, 2025, 12:25 PM by user: 1181 - Saved: 6/18/2025 by user: 1181
 L:\UD_Projects\UD25002 - Lawton-Joyce Park\UD25002\GRF.dwg

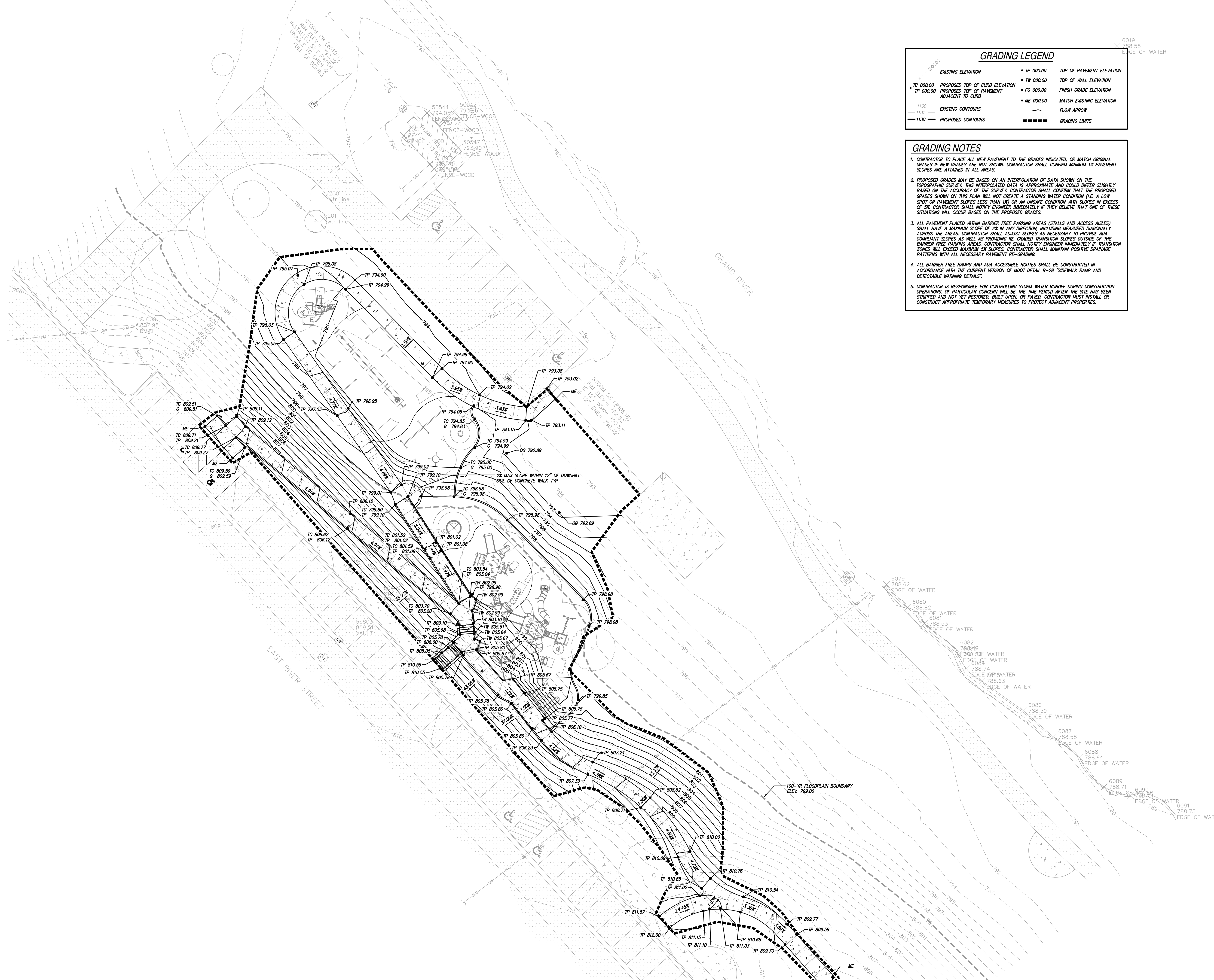

GRADING LEGEND

— 800.00 —	EXISTING ELEVATION	• TP 000.00	TOP OF PAVEMENT ELEVATION
• TC 000.00	PROPOSED TOP OF CURB ELEVATION	• TW 000.00	TOP OF WALL ELEVATION
TP 000.00	PROPOSED TOP OF PAVEMENT ADJACENT TO CURB	• FG 000.00	FINISH GRADE ELEVATION
— 11.30 —	EXISTING CONTOURS	• ME 000.00	MATCH EXISTING ELEVATION
— 11.31 —	PROPOSED CONTOURS	—	FLOW ARROW
— 11.30 —	EXISTING CONTOURS	—	GRADING LIMITS

- GRADING NOTES**
- CONTRACTOR TO PLACE ALL NEW PAVEMENT TO THE GRADES INDICATED, OR MATCH ORIGINAL GRADES IF NEW GRADES ARE NOT SHOWN. CONTRACTOR SHALL CONFIRM MINIMUM 1% PAVEMENT SLOPES ARE ATTAINED IN ALL AREAS.
 - PROPOSED GRADES MAY BE BASED ON AN INTERPOLATION OF DATA SHOWN ON THE TOPOGRAPHIC SURVEY. THIS INTERPOLATED DATA IS APPROXIMATE AND COULD DIFFER SLIGHTLY BASED ON THE ACCURACY OF THE SURVEY. CONTRACTOR SHALL CONFIRM THAT THE PROPOSED GRADES SHOWN ON THIS PLAN WILL NOT CREATE A STANDING WATER CONDITION (I.E. A LOW SPOT OR PAVEMENT SLOPES LESS THAN 1%) OR AN UNSAFE CONDITION WITH SLOPES IN EXCESS OF 5%. CONTRACTOR SHALL NOTIFY ENGINEER IMMEDIATELY IF THEY BELIEVE THAT ONE OF THESE SITUATIONS WILL OCCUR BASED ON THE PROPOSED GRADES.
 - ALL PAVEMENT PLACED WITHIN BARRIER FREE PARKING AREAS (STALLS AND ACCESS AISLES) SHALL HAVE A MAXIMUM SLOPE OF 2% IN ANY DIRECTION, INCLUDING MEASURED DIAGONALLY ACROSS THE AREAS. CONTRACTOR SHALL ADJUST SLOPES AS NECESSARY TO PROVIDE ADA COMPLIANT SLOPES AS WELL AS PROVIDING RE-GRADED TRANSITION SLOPES OUTSIDE OF THE BARRIER FREE PARKING AREAS. CONTRACTOR SHALL NOTIFY ENGINEER IMMEDIATELY IF TRANSITION ZONES WILL EXCEED MAXIMUM 5% SLOPES. CONTRACTOR SHALL MAINTAIN POSITIVE DRAINAGE PATTERNS WITH ALL NECESSARY PAVEMENT RE-GRADEING.
 - ALL BARRIER FREE RAMPS AND ADA ACCESSIBLE ROUTES SHALL BE CONSTRUCTED IN ACCORDANCE WITH THE CURRENT VERSION OF MDOT DETAIL R-28 "SIDEWALK RAMP AND DETECTABLE WARNING DETAILS".
 - CONTRACTOR IS RESPONSIBLE FOR CONTROLLING STORM WATER RUNOFF DURING CONSTRUCTION OPERATIONS. OF PARTICULAR CONCERN WILL BE THE TIME PERIOD AFTER THE SITE HAS BEEN STRIPPED AND NOT YET RESTORED, BUILT UPON, OR PAVED. CONTRACTOR MUST INSTALL OR CONSTRUCT APPROPRIATE TEMPORARY MEASURES TO PROTECT ADJACENT PROPERTIES.

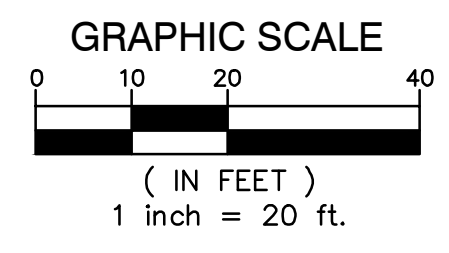

SPALDING DeDECKER
 Engineers | Planners | Surveyors
 Excellence Since 1954
 313 N. Capitol Ave, Suite 100
 Lansing, MI 48933
 Phone (517) 679-4400
Headquarters
 Rochester Hills
Branch Offices
 Detroit | Grand Rapids | Novi | Lansing

www.sda-eng.com
 (800) 598-1600



811
 Know what's below.
 Call before you dig.

PRIOR TO CONSTRUCTION, ALL LOCATIONS AND DEPTHS OF EXISTING UTILITIES (IN CONFLICT WITH PROPOSED IMPROVEMENTS) SHALL BE VERIFIED IN THE FIELD. CALL MISS DIG 3 WORKING DAYS PRIOR TO CONSTRUCTION.

UTILITY NOTE

UTILITY INFORMATION ON THIS DRAWING MAY BE FROM INFORMATION DISCLOSED TO THIS FIRM BY THE VARIOUS UTILITY COMPANIES, CITY/COUNTY AGENCIES AND OTHER VARIOUS SOURCES. UNDERGROUND UTILITIES WHICH ARE ON PRIVATE PROPERTY ARE USUALLY NOT DELINEATED UPON A UTILITY COMPANY'S PUBLISHED PLANS. THEIR LOCATION, IF SHOWN UPON THIS SURVEY, ARE APPROXIMATED FROM FOUND PAINT MARKS/STAKES, ETC. AS LOCATED BY THIS FIRM FROM SOURCES WHICH ARE UNKNOWN. NO GUARANTEE IS GIVEN AS TO THE COMPLETENESS OR ACCURACY THEREOF.

COPYRIGHT © SPALDING DEDECKER ASSOCIATES, INC. THIS DRAWING AND THE SUBJECT MATTER CONTAINED THEREON IS PROPRIETARY AND IS NOT TO BE USED OR REPRODUCED WITHOUT WRITTEN PERMISSION OF SPALDING DEDECKER ASSOCIATES, INC.

JAYCEE PARK PLAYGROUND IMPROVEMENTS
 525 E RIVER ST.
 GRAND LEDGE, MI

GRADING PLAN

TOWN - 4 NORTH RANGE - 4 WEST
 GRAND LEDGE
 EATON COUNTY, MICHIGAN

NO.	DATE	REVISION
01	06.18.2025	FOR BIDS

VERIFY SCALES
 BAR IS ONE INCH ON ORIGINAL DRAWING
 IF NOT ONE INCH ON THIS SHEET,
 ADJUST SCALES ACCORDINGLY

DRAFTER NW	DATE 5/22/2025
DESIGNER NW	DATE 4/30/2025
CHECKED RF	DATE 5/22/2025
PROJECT MANAGER NW	BID PLAN DATE
DEPARTMENT MANAGER APPROVAL TD	DATE
JOB NO. UD25002	DRAWING NO. UD25002GRP
SCALE: 1" = 20'	SHEET NO. C6.0

Plotted: Jun 18, 2025, 12:25 PM by user: 1181 - Saved: 6/18/2025 by user: 1181
 L:\UD_Projects\UD25002 - Lawton-Jaycee Park\UD25002SEC.dwg

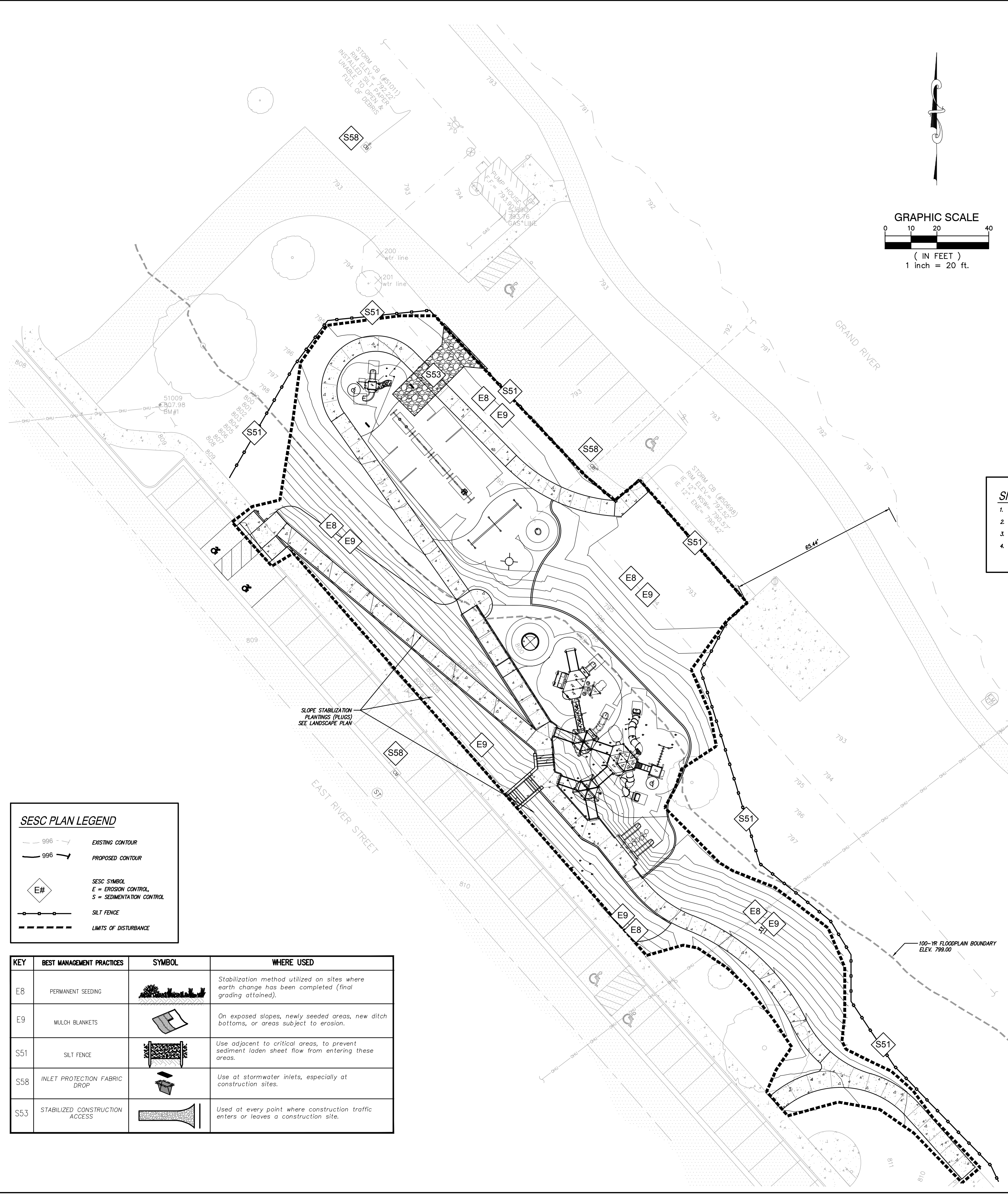

SESC PLAN LEGEND

	EXISTING CONTOUR
	PROPOSED CONTOUR
	SESC SYMBOL
	E = EROSION CONTROL
	S = SEDIMENTATION CONTROL
	SILT FENCE
	LIMITS OF DISTURBANCE

KEY	BEST MANAGEMENT PRACTICES	SYMBOL	WHERE USED
E8	PERMANENT SEEDING		Stabilization method utilized on sites where earth change has been completed (final grading attained).
E9	MULCH BLANKETS		On exposed slopes, newly seeded areas, new ditch bottoms, or areas subject to erosion.
S51	SILT FENCE		Use adjacent to critical areas, to prevent sediment laden sheet flow from entering these areas.
S58	INLET PROTECTION FABRIC DROP		Use at stormwater inlets, especially at construction sites.
S53	STABILIZED CONSTRUCTION ACCESS		Used at every point where construction traffic enters or leaves a construction site.



National Flood Hazard Layer FIRMette

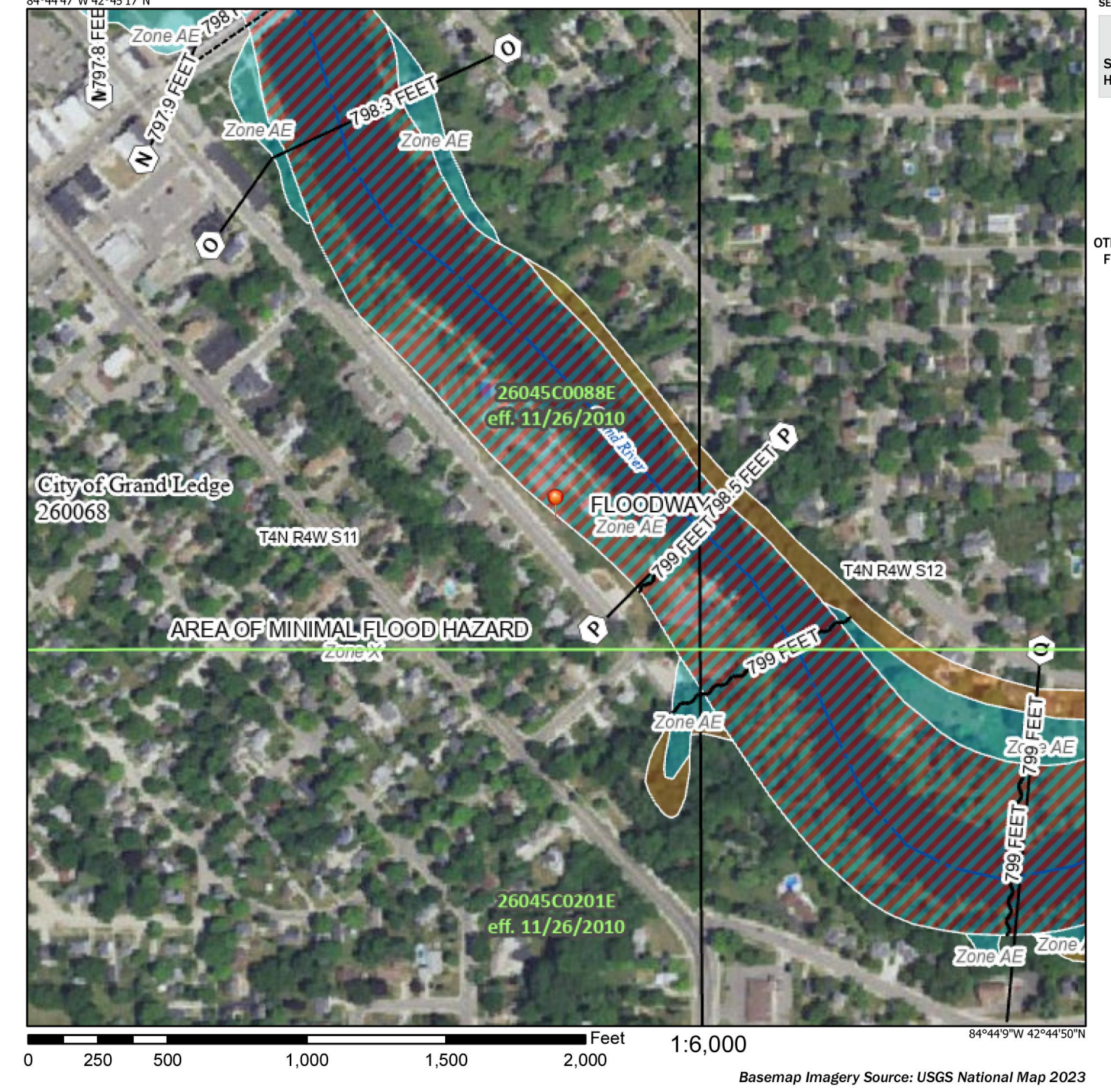

Legend

SEE THIS REPORT FOR DETAILED LEGEND AND INDEX MAP FOR FIRM PANEL LAYOUT

SPECIAL FLOOD HAZARD AREAS

- Without Base Flood Elevation (BFE)
- With BFE or Depth Zone AE, AF, AH, VE, AR
- Regulatory Floodway

OTHER AREAS OF FLOOD HAZARD

- 0.2% Annual Chance Flood Hazard, Areas of 1% annual chance flood with average depth less than one foot or with drainage areas of less than one square mile Zone X
- Future Conditions 1% Annual Chance Flood Hazard Zone X
- Area with Reduced Flood Risk due to Levee, See Notes, Zone X
- Area with Flood Risk due to Levee, Zone X

OTHER AREAS

- no screen Area of Minimal Flood Hazard Zone X
- Effective LOMRs
- Area of Undetermined Flood Hazard Zone X

OTHER AREAS

- Channel, Culvert, or Storm Sewer
- Levee, Dike, or Floodwall

STRUCTURES

- Cross Sections with 1% Annual Chance
- Water Surface Elevation
- Coastal Traverset
- Base Flood Elevation Line (BFE)
- Limit of Study
- Jurisdiction Boundary
- Coastal Traverset Baseline
- Profile Baseline
- Hydrographic Feature

OTHER FEATURES

- Digital Data Available
- No Digital Data Available
- Unmapped

MAP PANELS

- The pin displayed on the map is an approximate point selected by the user and does not represent an authoritative property location.

This map complies with FEMA's standards for the use of digital flood maps if it is not void as described below. The basemap shown complies with FEMA's basemap accuracy standards.

The flood hazard information is derived directly from the authoritative NFHL web services provided by FEMA. This map was exported on 6/17/2025 at 7:57 PM and does not reflect changes or amendments subsequent to this date and time. The NFHL, and effective information may change or become superseded by new data over time.

This map image is void if the one or more of the following map elements do not appear: basemap imagery, flood zone labels, legend, scale bar, map creation date, community identifiers, FIRM panel number, and FIRM effective date. Map images for unmapped and unmodernized areas cannot be used for regulatory purposes.

Basemap Imagery Source: USGS National Map 2023

- SITE DISTURBANCE NOTES**
- 100-YR FLOODPLAIN ELEVATION = 799.00
 - AREA OF DISTURBANCE = 0.62 ACRES
 - NEAREST WATER BODY IS THE GRAND RIVER
 - DISTURBANCE FROM CLOSEST DISTURBED AREA TO THE GRAND RIVER = 65.44'

- SOIL EROSION NOTES**
- ALL SESC MEASURES DESCRIBED ON THIS PLAN MUST BE INSTALLED AND PROPERLY MAINTAINED THROUGHOUT CONSTRUCTION ACTIVITIES.
 - THE CONTRACTOR SHALL BE RESPONSIBLE FOR ADHERING TO ALL THE REQUIREMENTS OF THE SOIL EROSION AND SEDIMENTATION CONTROL PLAN.
 - THE CONTRACTOR SHALL BE RESPONSIBLE FOR THE INSTALLATION OF ALL TEMPORARY SOIL EROSION CONTROL MEASURES PRIOR TO OR AT THE COMMENCEMENT OF CONSTRUCTION ACTIVITY. THE CONTRACTOR SHALL BE RESPONSIBLE FOR CHECKING ALL SOIL EROSION CONTROL MEASURES DAILY FOR EFFECTIVENESS AND FOR REPAIR, AS NEEDED.
 - STOCKPILE AREAS ARE TO BE LOCATED AT LEAST 50 FEET FROM SENSITIVE AREAS SUCH AS STREAMS, LAKES, AND WETLANDS AND AT LEAST 50 FEET FROM ALL PROPERTY BOUNDARIES. STOCKPILES SHALL NOT BE WITHIN TREE PROTECTION ZONES. STOCKPILE AREAS SHALL BE TEMPORARILY STABILIZED WITH A COVER CROP OR GEO-MEMBRANE IF LEFT INACTIVE FOR GREATER THAN 30 DAYS.
 - CONTRACTOR MUST STRICTLY MAINTAIN DUST CONTROL AT ALL TIMES DURING CONSTRUCTION AND UNTIL THE PROJECT IS CLOSED.
 - ANY CATCH BASIN LOCATED ON-SITE OR WITHIN 50 FEET OF THE CONSTRUCTION DISTURBANCE SHALL HAVE TEMPORARY INLET PROTECTION, FLEXSTORM CATCH-INLET FILTERS OR APPROVED EQUIVALENT.
 - ALL TEMPORARY SOIL EROSION CONTROL MEASURES SHALL BE REMOVED AFTER SEED IS ESTABLISHED AND PRIOR TO CLOSE OF CONTRACT.
 - ANY STORM SEWER EASEMENTS SHALL REMAIN FREE OF FENCES, EQUIPMENT, ETC. SO AS TO ALLOW MAINTENANCE VEHICLES TO SERVICE THE STORM SEWER SYSTEM.
 - DIRT TRACKED OFF SITE ONTO PUBLIC ROADS SHALL BE PROMPTLY REMOVED, NO LESS THAN ON A DAILY BASIS.
 - ANY SURPLUS SOIL SHALL BE BERMED ON THE SITE IN AN AREA DESIGNATED BY THE OWNER.
 - THIS SOIL EROSION PLAN DOES NOT AUTHORIZE CONNECTION TO ANY COUNTY DRAIN, OCCUPATION OF ANY EASEMENT OF A COUNTY DRAIN, OR CROSSING OF ANY COUNTY DRAIN. A SEPARATE TAKE-IN PERMIT, OCCUPATION LICENSE, OR CROSSING PERMIT MUST BE ISSUED BY THE DRAIN COMMISSIONER PRIOR TO ANY SUCH WORK. PERMITS TO CROSS OR CONNECT THE COUNTY DRAINS WILL NOT BE ISSUED UNTIL ALL PERMITS ARE ISSUED BY THE MICHIGAN DEPARTMENT OF ENVIRONMENT, GREAT LAKES, AND ENERGY (EGLE) FOR THAT WORK, AND COPIES OF SAME ARE SUBMITTED TO THE DRAIN COMMISSIONER.
 - THIS SOIL EROSION PLAN DOES NOT AUTHORIZE ANY EARTH DISTURBANCE ACTIVITY IN STATE REGULATED WETLANDS UNTIL A PERMIT, OBTAINED FROM EGLE, IS SUBMITTED AUTHORIZING THAT EARTH DISTURBANCE ACTIVITY OR SEDIMENTATION OF THE WETLANDS.
 - THIS SOIL EROSION PLAN DOES NOT AUTHORIZE ANY EARTH DISTURBANCE ACTIVITY OFF-SITE UNTIL PERMISSION IS OBTAINED AND SUBMITTED TO THE EATON COUNTY DRAIN COMMISSIONER FROM THE LANDOWNERS OF THOSE PROPERTIES ON WHICH THE DISTURBANCE IS TO OCCUR AND A SOIL EROSION PLAN IS SUBMITTED AND APPROVED BY EATON COUNTY FOR THAT WORK, INCLUDING, BUT NOT LIMITED TO, PLACEMENT OF EXCAVATED MATERIAL FROM THIS SITE.

- SEEDING NOTES**
- SEED ALL NON NATIVE DISTURBED AREAS UNLESS OTHERWISE NOTED WITH:
 EARTH CARPET QUICK TO GROW LAWN SEED MIXTURE
 25% PERENNIAL RYEGRASS
 25% KENTUCKY BLUEGRASS
 25% ANNUAL RYEGRASS
 25% CREEPING RED FESCUE
 - MULCH BLANKETS SHALL BE USED ON ALL SLOPES 10% OR GREATER.
- APPLY AT THE RATE OF 5-8 POUNDS PER 1,000SQ'

LEGAL DESCRIPTION

ENTIRE BLOCK O. P. BLOCK 51 CITY OF GRAND LEDGE D.D.A.
 AND
 LOTS 1, 2, 3, 4 & 5, O.P. BLOCK 50 CITY OF GRAND LEDGE D.D.A.

SPALDING DeDECKER
 Engineers | Planners | Surveyors
 Excellence Since 1954
 313 N. Capitol Ave, Suite 100
 Lansing, MI 48933
 Phone (517) 679-4400
 Headquarters
 Rochester Hills
 Branch Offices
 Detroit | Grand Rapids | Novi | Lansing

 www.sda-eng.com
 (800) 598-1600

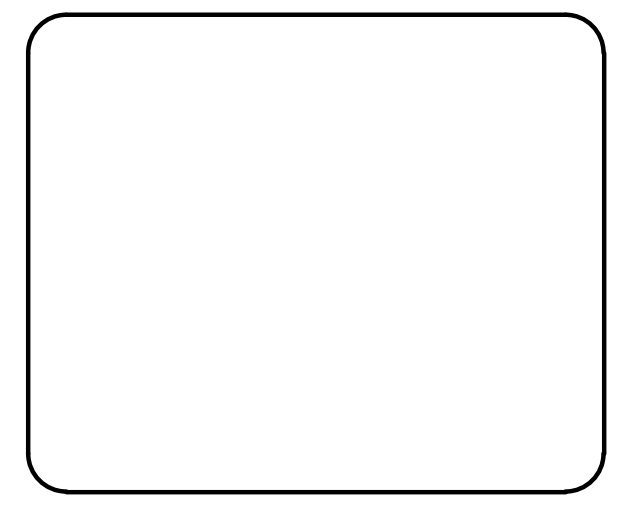

UTILITY NOTE

UTILITY INFORMATION ON THIS DRAWING MAY BE FROM INFORMATION DISCLOSED TO THIS FIRM BY THE VARIOUS UTILITY COMPANIES, CITY/COUNTY AGENCIES AND OTHER VARIOUS SOURCES. UNDERGROUND UTILITIES WHICH ARE ON PRIVATE PROPERTY ARE USUALLY NOT DELINEATED UPON A UTILITY COMPANY'S PUBLISHED PLANS. THEIR LOCATION, IF SHOWN UPON THIS SURVEY, ARE APPROXIMATED FROM FOUND PAINT MARKS/STAKES, ETC. AS LOCATED BY THIS FIRM FROM SOURCES WHICH ARE UNKNOWN. NO GUARANTEE IS GIVEN AS TO THE COMPLETENESS OR ACCURACY THEREOF.

COPYRIGHT © SPALDING DeDECKER ASSOCIATES, INC. THIS DRAWING AND THE SUBJECT MATTER CONTAINED THEREIN IS PROPRIETARY AND IS NOT TO BE USED OR REPRODUCED WITHOUT WRITTEN PERMISSION OF SPALDING DeDECKER ASSOCIATES, INC.

JAYCEE PARK PLAYGROUND IMPROVEMENTS

525 E RIVER ST.
 GRAND LEDGE, MI

SESC PLAN

TOWN - 4 NORTH RANGE - 4 WEST
 GRAND LEDGE
 EATON COUNTY, MICHIGAN

NO.	DATE	REVISION
01	06.18.2025	FOR BIDS

VERIFY SCALES
 BAR IS ONE INCH ON ORIGINAL DRAWING
 IF NOT ONE INCH ON THIS SHEET,
 ADJUST SCALES ACCORDINGLY

DRAWER NW	DATE 5/22/2025
DESIGNER NW	DATE 4/30/2025
CHECKED RF	DATE 5/22/2025
PROJECT MANAGER NW	BID PLAN DATE
DEPARTMENT MANAGER APPROVAL TD	DATE
JOB NO. UD25002	DRAWING NO. UD25002SEC
SCALE: 1" = 20'	SHEET NO. C7.0

E8 PERMANENT SEEDING SPECIFICATIONS

- When**
- To finalize stabilization of temporary seeding areas or when an area needs permanent stabilization following completion of construction. Also used when vegetative establishment can correct existing soil erosion or sedimentation problem.
 - Within 5 days of final grade.
- Why**
- To stabilize soil and prevent or reduce soil erosion/sedimentation problems from developing.
- Where**
- Used on construction and earth change sites which require permanent vegetative stabilization.
- How**
- Review SESC plan and construction phasing to identify areas in need of permanent vegetative stabilization.
 - Select perennial grass and ground cover for permanent cover.
 - Seed mixes vary. However, they should contain native species.
 - Seed mixes should be selected through consultation with a certified seed provider and with consideration of soil type, light, moisture, urea applications, and native species content.
 - Soil tests should be performed to determine the nutrient and pH levels in the soil. The pH may need to be adjusted to between 6.5 and 7.0.
 - Prepare a 3-5" deep seedbed, with the top 3-4" consisting of topsoil.
 - Slopes steeper than 1:3 should be roughened.
 - Apply seed as soon as possible after seedbed preparation. Seed may be broadcast by hand, hydroseeding, or by using mechanical drills.
 - Mulch immediately after seeding.
 - Dormant seed mixes are for use after the growing season, using seed which lies dormant in the winter and begins growing as soon as site conditions become favorable.



PERMANENT SEEDING SPECIFICATIONS E8

- How (cont.)**
- Protect seeded areas from pedestrian or vehicular traffic.
 - Divert concentrated flows away from the seeded area until vegetation is established.
- Maintenance**
- Inspect weekly and within 24 hours following each rain event in the first few months following installation to be sure seed has germinated and permanent vegetative cover is being established.
 - Add supplemental seed as necessary.
- Limitations**
- Seeds need adequate time to establish.
 - May not be appropriate in areas with frequent traffic.
 - Seeded areas may require irrigation during dry periods.
 - Seeding success is site specific, consider mulching or sodding when necessary.



E8 PERMANENT SEEDING

Planting Zones:	Lower Peninsula (South of 120N) Zone 1	Lower Peninsula (North of 120N) Zone 2	Upper Peninsula Zone 3
Seeding Window Permanent Seeding	4/15 - 10/10	5/1 - 10/1	5/1 - 9/20
Seeding Window Dormant Seeding*	11/15 - Freeze	11/01 - Freeze	11/01 - Freeze

Source: Adapted from MDOT Interim 2003 Standard Specifications for Construction

	Zone 1	Zone 2	Zone 3
Seeding Dates (with irrigation or Mulch)	4/1 - 8/1	5/1 - 9/20	5/1 - 9/10
Seeding Dates (w/o irrigation or Mulch)	4/1 - 5/20 8/10 - 10/1	5/1 - 6/10 8/1 - 9/20	5/1 - 6/15 8/1 - 9/20
Dormant Seeding Dates*	11/1 - Freeze	10/25 - Freeze	10/25 - Freeze

Source: Adapted from USDA NRCS Technical Guide #342 (1999)

* Dormant seeding is for use in the late fall after the soil temperature remains consistently below 50°F, prior to the ground freezing. This practice is appropriate if construction on a site is completed in the fall but the seed was not planted prior to recommended seeding dates. No seed germination will take place until spring. A cool season annual grass may be added in an attempt to have some fall growth.

- Mulch must be used with dormant seed.
- Do not seed when the ground is frozen or snow covered.
- Do not use a dormant seed mix on grassed waterways.



E9 MULCH BLANKETS

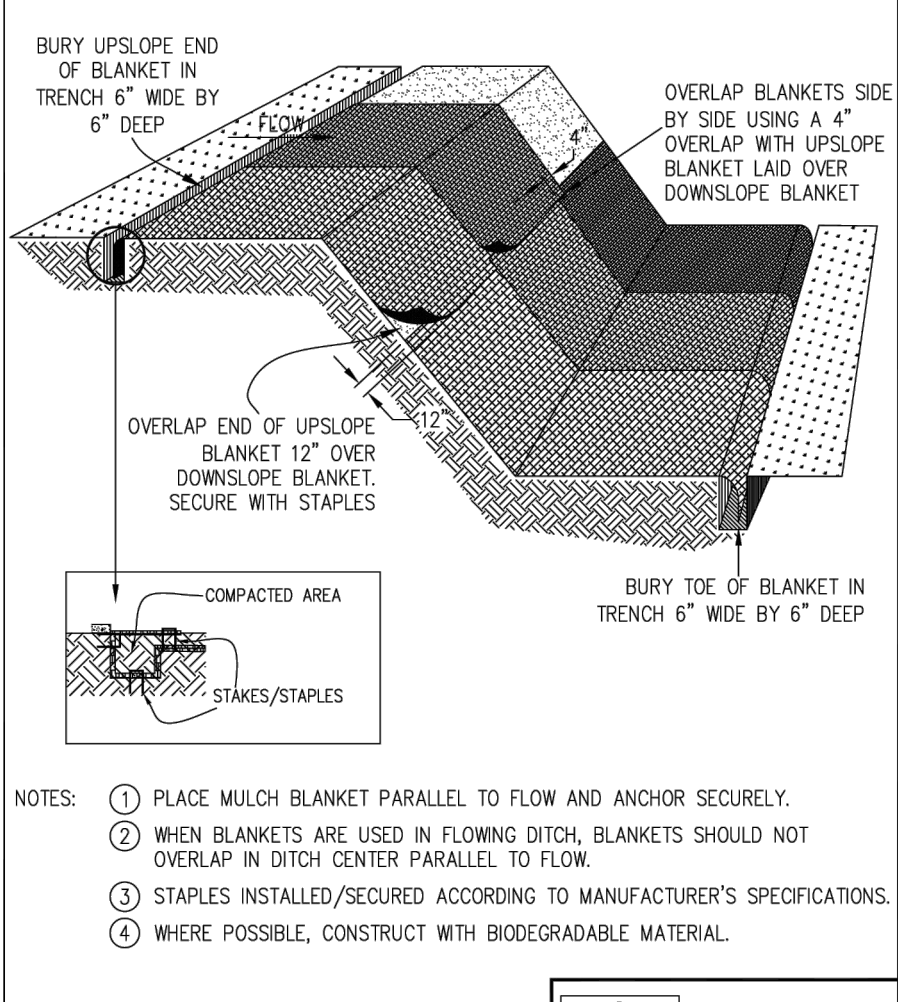

E9 MULCH BLANKETS SPECIFICATIONS

- When**
- When seeded areas are subject to erosive surface flows, severe wind, or to protect non-vegetated slopes or areas during the winter.
- Why**
- Protects seeded areas and slopes against erosion from rain or wind. Holds soil moisture to allow for seed germination and reduces wind desiccation of germinated seeds.
- Where**
- Use on exposed slopes, newly seeded areas, new ditch bottoms, and other areas subject to erosion.
- How**
- Prepare subgrade to proper grade and compaction requirements.
 - Remove ruts, roots, soil clods, or other debris from surface subject to mulch blanket installation.
 - Spread or drill seed.
 - Consult with erosion control material supplier to select mulch blanket based on slope gradient, expected surface run-off, and protection term necessary (long or short term).
 - Position selected mulch blanket as close as possible to intended use location.
 - Install blanket at top of slope, first anchoring toe in trench 6" wide X 6" deep, progressing down-slope or down-gradient with approximately 12" of blanket extended beyond the up-slope portion of the trench.
 - Anchor the blanket with staples/stakes placed approximately 12" apart in the bottom of the trench. Backfill and compact the trench after securing.
 - Apply seed to compacted soil and fold the 12" portion of the blanket over compacted area and secure with a row of staples/stakes placed 12" apart across the width of the blanket.
 - Unroll the blankets down or horizontally across the slope.



E9 MULCH BLANKETS SPECIFICATIONS

- How (cont.)**
- Overlap blanket edges by a minimum of 4" and blanket ends by a minimum of 12". Overlaps should be in the direction of expected flow with the up-slope blanket placed over the down-slope blanket edge.
 - Secure down-slope end of blanket with staples/stakes and trench in mulch blanket installation.
- Maintenance**
- Check after a rain event to ensure the blanket is still in place.
 - Keep eroded soil, vehicular and pedestrian traffic, and concentrated runoff away from the blanketed area.
- Limitations**
- Mulch blankets and anchors may inhibit mowing.



S51 SILT FENCE

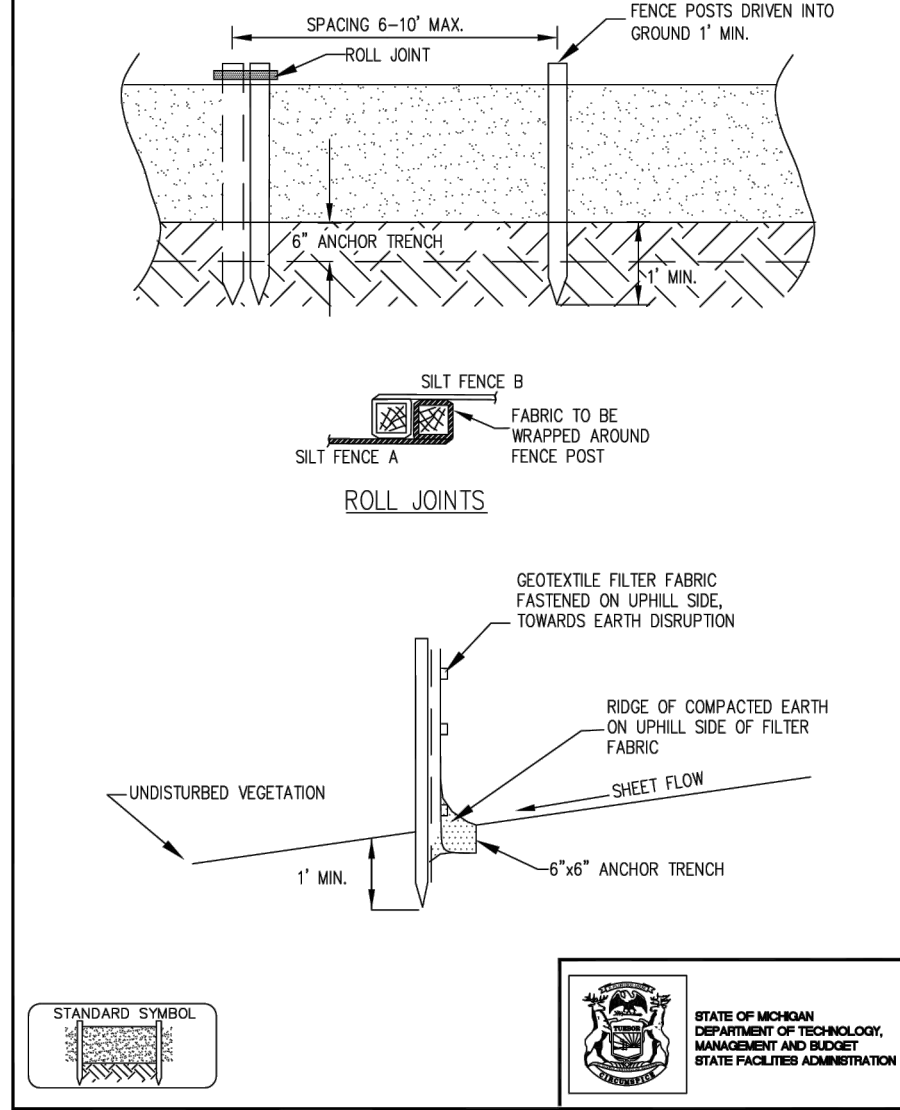

SILT FENCE SPECIFICATIONS S51

- When**
- A temporary measure for preventing sediment movement.
- Why**
- Used to prevent sediment suspended in runoff from leaving an earth change area.
- Where**
- Use adjacent to critical areas, wetlands, base of slopes, and watercourses.
- How**
- Install parallel to a contour.
 - The silt fence should be made of woven geotextile fabric.
 - Silt fence should accommodate no more than 1/2 to 1 acre of drainage per 100' of fence.
 - Dig a 6" trench along the area where the fence is to be installed.
 - Place 6" of the silt fence bottom flap into the trench.
 - Backfill the trench with soil and compact the soil on both sides. Create a small ridge on the up-slope side of the fence.
 - Install wooden stakes 6 - 10' apart and drive into the ground a minimum of 12".
 - Staple the geotextile fabric to the wooden stakes.
 - Join sections of silt fence by wrapping ends together (See drawing).
- Maintenance**
- Inspect frequently and immediately after each storm event. Check several times during prolonged storm events. If necessary, repair immediately.
 - If the sediment has reached 1/3 the height of the fence, the soil should be removed and disposed of in a stable upland site.
 - The fence should be re-installed if water is seeping underneath it or if the fence has become ineffective.
 - Silt fence should be removed once vegetation is established and up-slope area has stabilized.



S51 SILT FENCE SPECIFICATIONS

- Limitations**
- Silt fence may cause temporary ponding and could fail if too much water flows through the area.
 - Do not use in areas with concentrated flows.
 - Chance of failure increases if fence is installed incorrectly or if sediment accumulation is not removed.

S53 STABILIZED CONSTRUCTION ACCESS

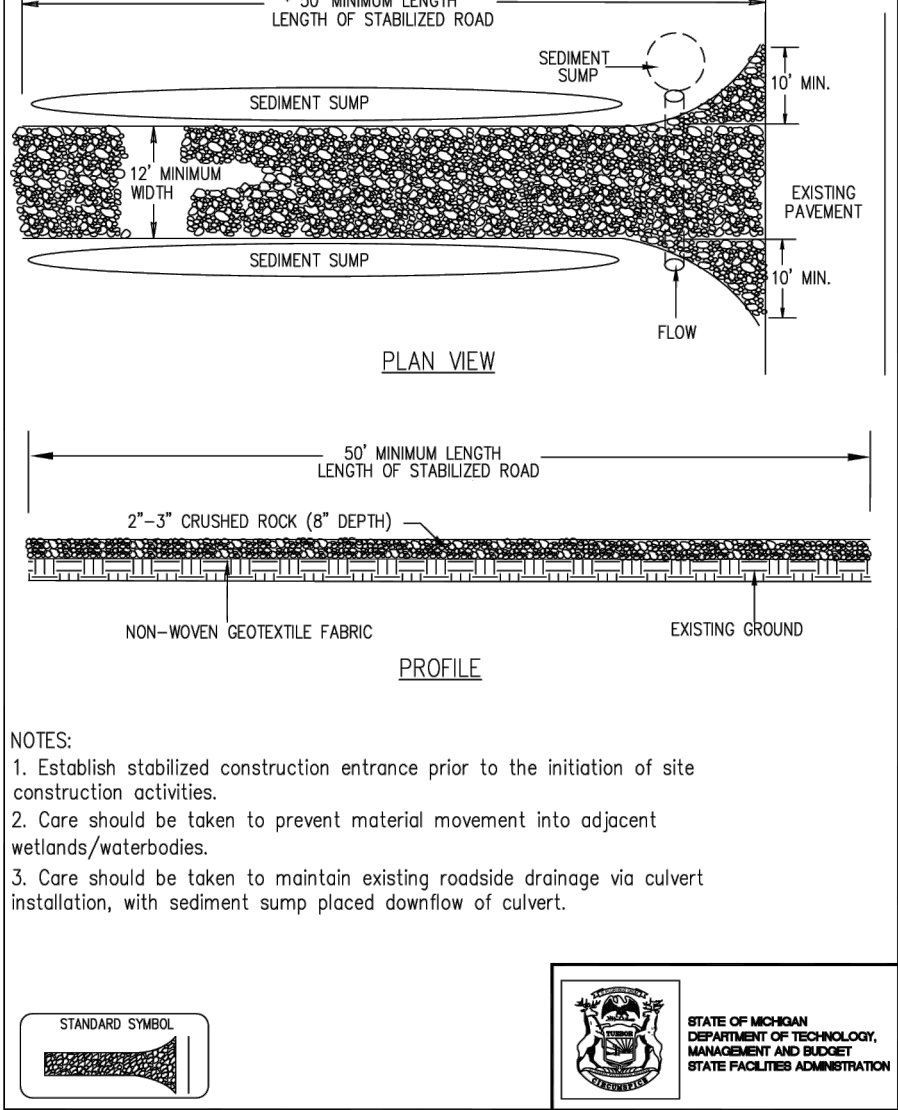

STABILIZED CONSTRUCTION ACCESS SPECIFICATIONS S53

- When**
- Construction traffic is expected to leave a construction site.
 - Stabilization of interior construction roads is desired.
- Why**
- To minimize tracking of sediment on public roadways and to minimize disturbance of vegetation.
- Where**
- Stabilized construction entrances shall be located at every point where construction traffic enters or leaves a construction site. Vehicles leaving the site must be routed over the rock ingress/egress corridor.
- How**
- Stabilized construction access road should be established at the onset of the construction activities and maintained in place for the duration of the construction project.
 - Installation of this practice should be the responsibility of the site clearing or excavating contractor.
 - Access location should be cleared of woody vegetation.
 - Non-woven geotextile fabric shall be placed over the existing ground prior to placing stone.
 - Access size should be a minimum of 50'. (30' for single residence lot).
 - Access width should be 12" minimum, flared at the existing road to provide a turning radius.
 - Crushed aggregate (2" to 3"), or reclaimed or recycled concrete equivalent, shall be placed at least 8" deep over the length and width of the ingress/egress corridor.
- Maintenance**
- Periodic inspection and needed maintenance shall be provided after each rain event.
 - Stabilized entrances shall be repaired and rock added as necessary.



STABILIZED CONSTRUCTION ACCESS SPECIFICATIONS S53

- Maintenance (cont.)**
- Sediment deposited on public rights-of-way shall be removed immediately and returned to the construction site.
 - If soils are such that washing of tires is required, it shall be done in a wash rock area, stabilized with stone, immediately prior to the construction access stabilized corridor.
 - At the project completion, rock access road should be removed and disposed of unless utilized as subgrade for final road.
- Limitations**
- Effectiveness limited, sediment may be tracked onto roads requiring additional action.



S58 INLET PROTECTION - FABRIC DROP

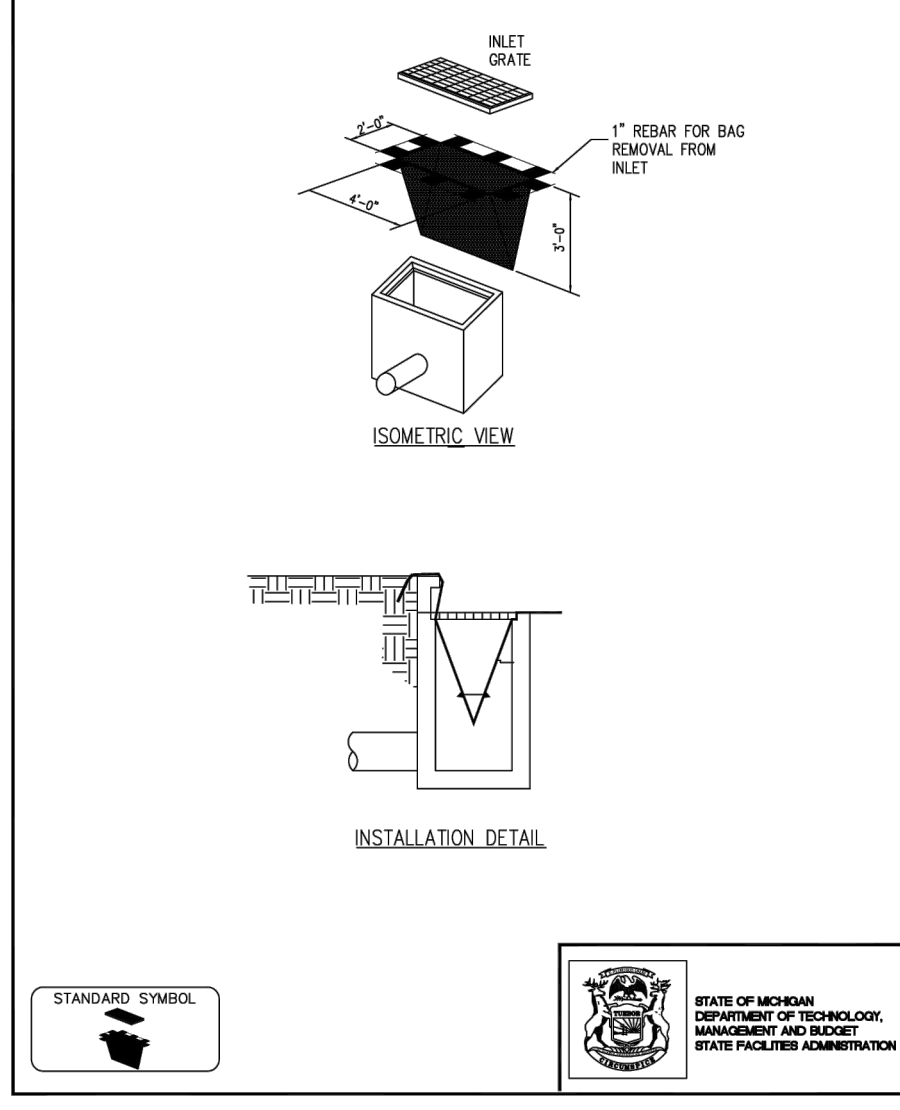

INLET PROTECTION - FABRIC DROP SPECIFICATIONS S58

- When**
- When sediment laden stormwater requires treatment before entering a stormwater drainage system.
- Why**
- To prevent sediment from entering stormwater systems.
- Where**
- Use in or at stormwater inlets, especially at construction sites or in streets.
- How**
- A filter fabric bag is hung inside the inlet, beneath the grate.
 - Replace grate, which will hold bag in place.
 - Anchor filter bag with 1" rebar for removal from inlet.
 - Flaps of bag that extend beyond the bag can be buried in soil in earth areas.
- Maintenance**
- Drop inlet filters should be inspected routinely and after each major rain event.
 - Damaged filter bags should be replaced.
 - Clean and/or replace filter bag when 1/2 full.
 - Replace clogged fabric immediately.
 - If needed, initiate repairs immediately upon inspection.
 - Remove entire protective mechanism when upgradient areas are stabilized and streets have been swept.
- Limitations**
- Can only accommodate small flow quantities.
 - Requires frequent maintenance.
 - Ponding may occur around storm drains if filter is clogged.



PROJECT SEQUENCING

- INSTALL TEMPORARY SESC MEASURES.
- PERFORM DEMOLITION AND RENOVALS.
- PERFORM EXCAVATION AND GRADING ACTIVITIES.
- INSTALL DRAIN TILES FOR RETAINING WALLS AND PLAYGROUND AREAS.
- CONSTRUCT RETAINING WALLS, PAVED PADS AND PATHWAYS.
- RESTORATION AND SEEDING SHALL BE INSTALLED IMMEDIATELY FOLLOWING ESTABLISHMENT OF FINAL GRADES.
- INSTALL PLAYGROUND EQUIPMENT.
- INSTALL PLAYGROUND SURFACING.
- INSTALL TREES, SHRUBS AND PLUGS.
- REMOVE TEMPORARY SESC MEASURES ONCE LAWN SEEDING AREAS HAVE BEEN ESTABLISHED.

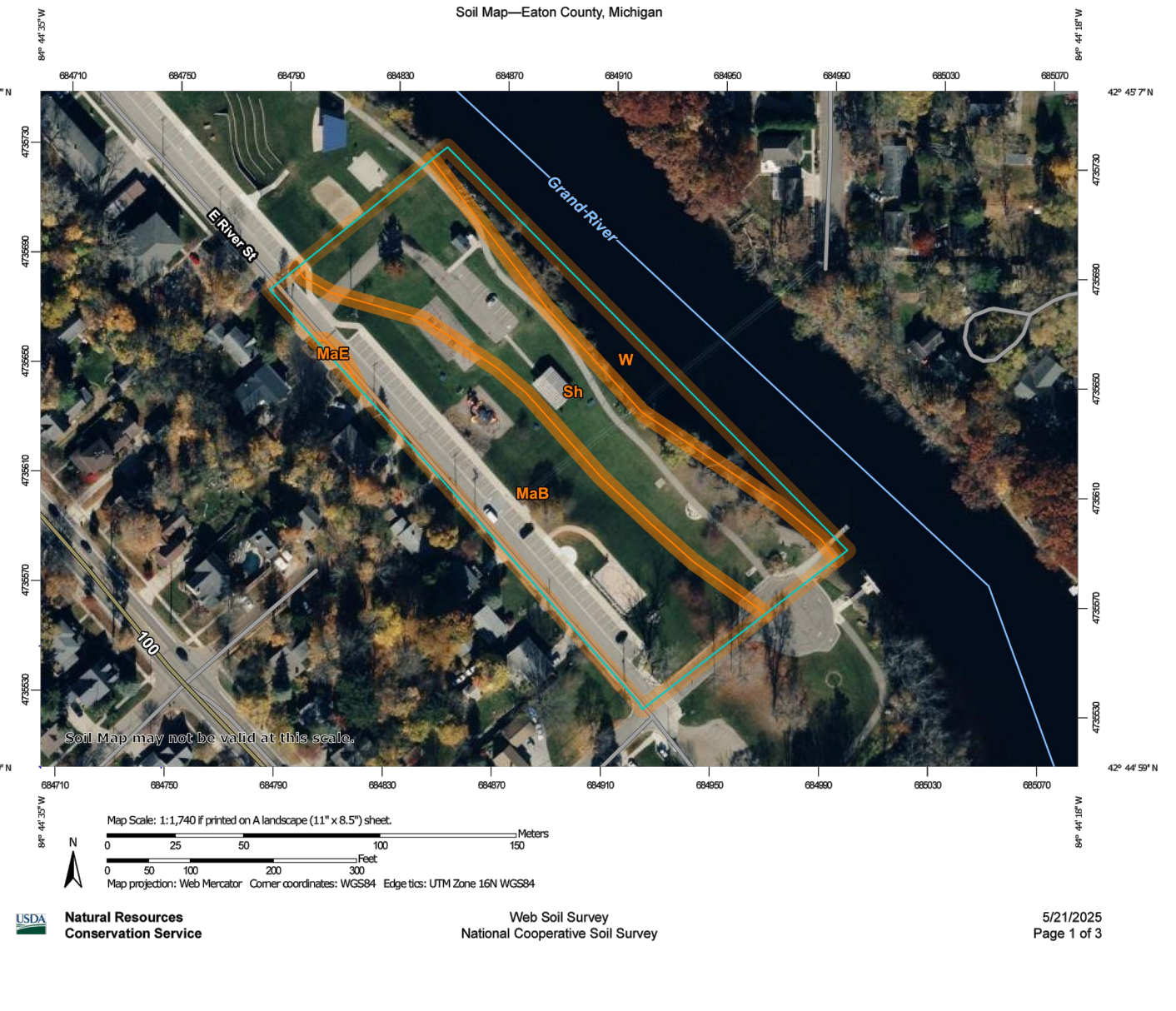

Map Unit Symbol	Map Unit Name	Acres in AOI	Percent of AOI
MaB	Marlette loam, 2 to 6 percent slopes	2.0	45.1%
MaE	Filer loam, 18 to 35 percent slopes	0.0	0.3%
Sh	Sheals-Sloan loams	1.8	40.9%
W	Water	0.6	13.7%
Totals for Area of Interest		4.5	100.0%

SPALDING DeDECKER
Engineers | Planners | Surveyors
Excellence Since 1954
313 N. Capitol Ave, Suite 100
Lansing, MI 48933
Phone (517) 679-4400
Headquarters
Rochester Hills
Branch Offices
Detroit | Grand Rapids | Novi | Lansing
www.sda-eng.com
(800) 598-1600

The City of Grand Ledge

811
Know what's below. Call before you dig.
PRIOR TO CONSTRUCTION, ALL LOCATIONS AND DEPTHS OF EXISTING UTILITIES IN CONFLICT WITH PROPOSED IMPROVEMENTS SHALL BE VERIFIED IN THE FIELD. CALL MISS DIG 3 WORKING DAYS PRIOR TO CONSTRUCTION.
UTILITY NOTE
UTILITY INFORMATION ON THIS DRAWING MAY BE FROM INFORMATION DISCLOSED TO THIS FIRM BY THE VARIOUS UTILITY COMPANIES, CITY/COUNTY AGENCIES AND OTHER VARIOUS SOURCES. UNDERGROUND UTILITIES WHICH ARE ON PRIVATE PROPERTY ARE USUALLY NOT DEPICTED FROM A UTILITY COMPANY'S PUBLISHED PLANS. THEIR LOCATION, IF SHOWN UPON THIS SURVEY, ARE APPROXIMATED FROM FOUND PAINT MARKS/STAKES, ETC. AS LOCATED BY THIS FIRM FROM SOURCES WHICH ARE UNKNOWN. NO GUARANTEE IS GIVEN AS TO THE COMPLETENESS OR ACCURACY THEREOF.
COPYRIGHT © SPALDING DEDECKER ASSOCIATES, INC. THIS DRAWING AND THE SUBJECT MATTER CONTAINED THEREON IS PROPRIETARY AND IS NOT TO BE USED OR REPRODUCED WITHOUT WRITTEN PERMISSION OF SPALDING DEDECKER ASSOCIATES, INC.

JAYCEE PARK PLAYGROUND IMPROVEMENTS
525 E RIVER ST.
GRAND LEDGE, MI
SESC DETAILS
TOWN - 4 NORTH RANGE - 4 WEST
GRAND LEDGE
EATON COUNTY, MICHIGAN

NO.	DATE	REVISION
01	06.18.2025	FOR BIDS

VERIFY SCALES
BAR IS ONE INCH ON ORIGINAL DRAWING
IF NOT ONE INCH ON THIS SHEET, ADJUST SCALES ACCORDINGLY

DRAWER	DATE
NW	5/22/2025

DESIGNER	DATE
NW	4/30/2025

CHECKED	DATE
RF	5/22/2025

PROJECT MANAGER	BID PLAN DATE
NW	

DEPARTMENT MANAGER APPROVAL	DATE
TD	

JOB NO.	DRAWING NO.
UD25002	UD25002SEC

SCALE:	SHEET NO.
NA	C7.1

NO.	DATE	REVISION
01	06.18.2025	FOR BIDS

VERIFY SCALES	
BAR IS ONE INCH ON ORIGINAL DRAWING	
IF NOT ONE INCH ON THIS SHEET, ADJUST SCALES ACCORDINGLY	
DRAWER NW	DATE 5/22/2025
DESIGNER NW	DATE 4/30/2025
CHECKED RF	DATE 5/22/2025
PROJECT MANAGER NW	BID PLAN DATE
DEPARTMENT MANAGER APPROVAL TD	DATE
JOB NO. UD25002	DRAWING NO. UD25002LSC
SCALE: 1"=20'	SHEET NO. L1.0

TREE SCHEDULE (THIS SHEET)

Qty.	ID	Botanical Name	Common Name	Size	Description
2	LS	LIQUIDAMBAR STRYACIFLUA	SWEET GUM	MIN 2.5" CALIPER	

PLUG SCHEDULE (THIS SHEET)

Qty.	ID	Botanical Name	Common Name	Size	SPACING
99	AG	ANDROPOGON GERARDI	BIG BLUESTEM	PLUG	24" O.C.
99	AS	AVENA SATIVA	COMMON OAT	PLUG	24" O.C.
99	BC	BOUTELOUA CURTIPENDULA	SIDE-OATS GRAMA	PLUG	24" O.C.
99	CS	CAREX SPP.	PRAIRIE SEDGE SPECIES	PLUG	24" O.C.
99	EC	ELYMUS CANADENSIS	CANADA WLD RYE	PLUG	24" O.C.
99	EV	ELYMUS VIRGINICUS	VIRGINIA WLD RYE	PLUG	24" O.C.
99	LM	LOLIUM MULTIFLORUM	ANNUAL RYE	PLUG	24" O.C.
99	PV	PANICUM VIRGATUM	SWITCH GRASS	PLUG	24" O.C.
101	SS	SCHIZACHYRIUM SCOPARIUM	LITTLE BLUESTEM	PLUG	24" O.C.
101	SN	SORGHASTRUM NUTANS	INDIAN GRASS	PLUG	24" O.C.

LANDSCAPE NOTES:

- INSTALL 3" X 12 GA. EDGING TO SEPARATE LAWN FROM PLANTING BED.
- INSTALL 3" DEEP SHREDED BARK MULCH TO ALL PLANTING AREAS / BEDS
- CONTRACTOR SHALL VERIFY THE LOCATION OF ALL UNDERGROUND UTILITIES, PIPES AND STRUCTURES, AS WELL AS THE LOCATION OF EXISTING TREES AND VEGETATION. CONTRACTOR SHALL BE RESPONSIBLE FOR ANY COST INCURRED DUE TO DAMAGE/REMOVAL OF SAID ELEMENTS.
- ANY DISCREPANCIES BETWEEN PLANS, NOTES, DETAILS AND EXISTING CONDITIONS SHALL BE IMMEDIATELY REPORTED TO THE OWNER'S AUTHORIZED REPRESENTATIVE FOR REVIEW AND DECISION. CONTRACTOR SHALL ASSUME FULL RESPONSIBILITY FOR ALL REVISIONS DUE TO FAILURE TO GIVE SUCH NOTIFICATION.
- CONTRACTOR IS RESPONSIBLE FOR ANY DAMAGE TO EXISTING MATERIALS/IMPROVEMENTS, DAMAGED DURING CONSTRUCTION.
- SITE BOUNDARY, TOPOGRAPHY, UTILITIES AND OTHER BASE INFORMATION PROVIDED BY OTHERS.
- CONTRACTOR SHALL VERIFY QUANTITIES SHOWN ON PLANT SCHEDULES AND THOSE INDICATED ON PLANS. CONTRACTOR IS RESPONSIBLE FOR INSTALLATION OF QUANTITIES DRAWN.
- CONTRACTOR SHALL MAKE MINOR ADJUSTMENTS TO PLANT MATERIAL LOCATIONS IN FIELD, AS NECESSARY. THE LOCATION OF ALL PLANT MATERIAL SHALL BE SUBJECT TO APPROVAL BY THE OWNER'S AUTHORIZED REPRESENTATIVE.
- ALL PLANT MATERIAL SHALL BE OF THE SIZES CALLED FOR IN THE PLANT SCHEDULES. ANY PLANT MATERIAL NOT MEETING THE SIZED AND/OR QUALITY AS CALLED FOR SHALL BE REMOVED FROM SITE. ALL TREES SHALL BE INSPECTED AND APPROVED BY THE OWNER'S AUTHORIZED REPRESENTATIVE. NO SUBSTITUTIONS OF PLANT MATERIAL SHALL BE MADE WITHOUT APPROVAL FROM THE OWNER'S AUTHORIZED REPRESENTATIVE.
- CONTRACTOR SHALL DETERMINE APPROPRIATE PLANTING BACKFILL MIXES (BASED ON SOILS/SUBSURFACE CONDITIONS) AND REVIEW ALTERNATIVES WITH OWNER'S AUTHORIZED REPRESENTATIVE PRIOR TO INSTALLATION.
- CONTRACTOR TO INCLUDE COST OF ALL MULCH IN THE COST OF THE PLANT MATERIAL.

